

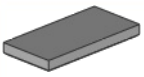







1

					
273x	2x	6x	2x	6x	2x

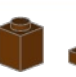

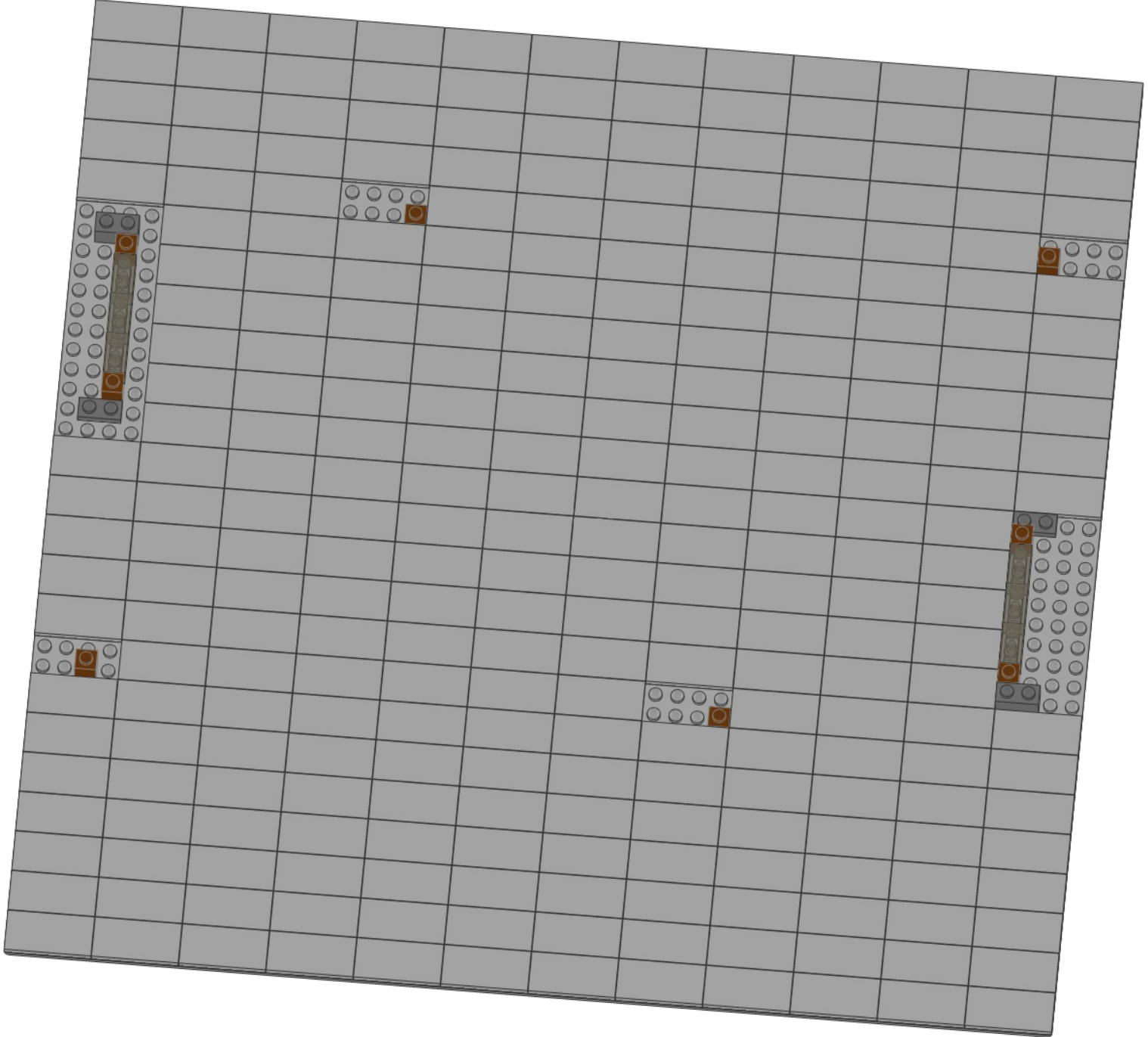

2

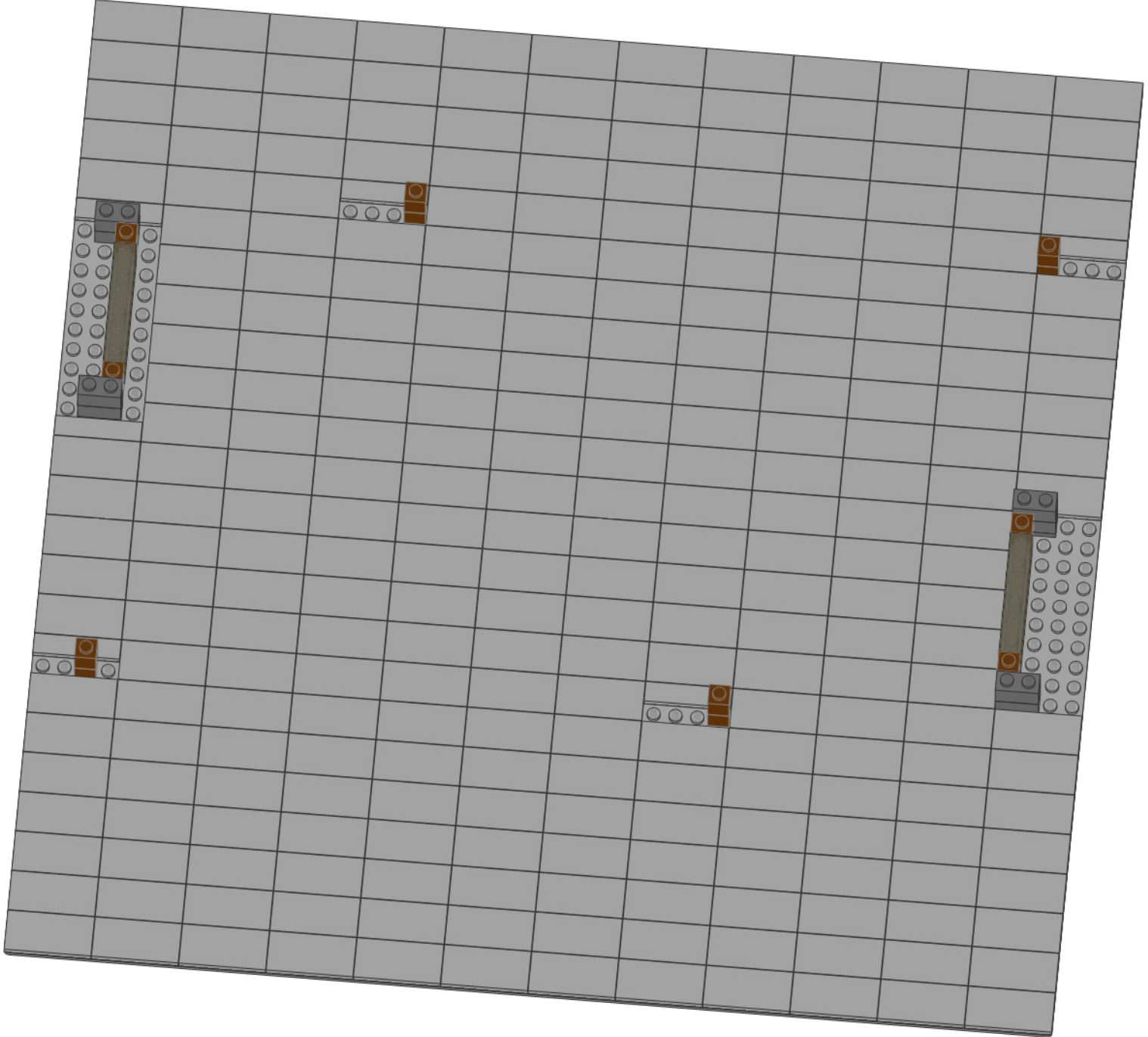
			
6x	10x	6x	6x

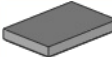
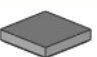
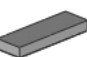
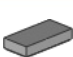

3

				
3x	4x	5x	7x	5x

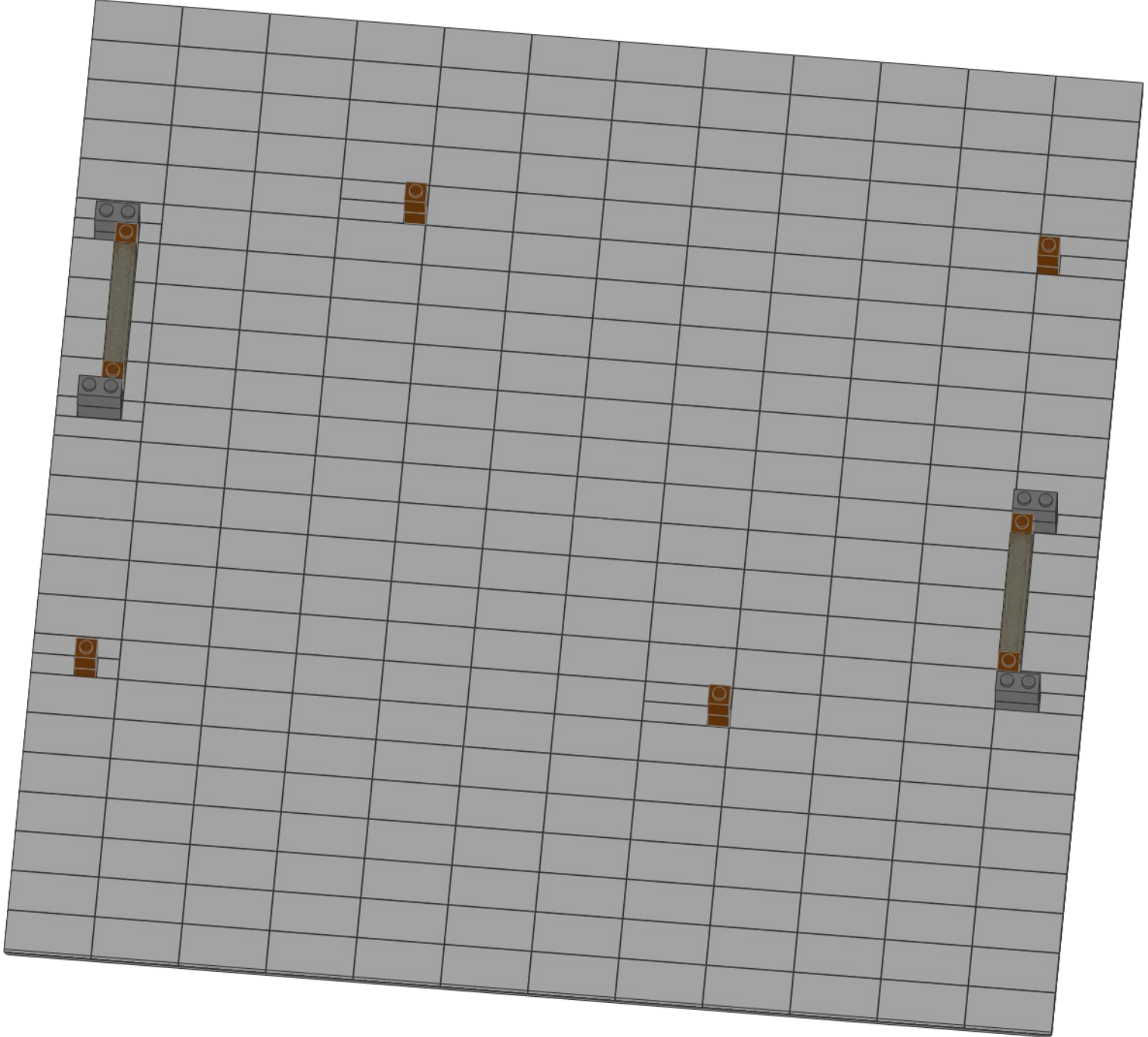

4

13x
1x 3x 24x 3x
4x 3x

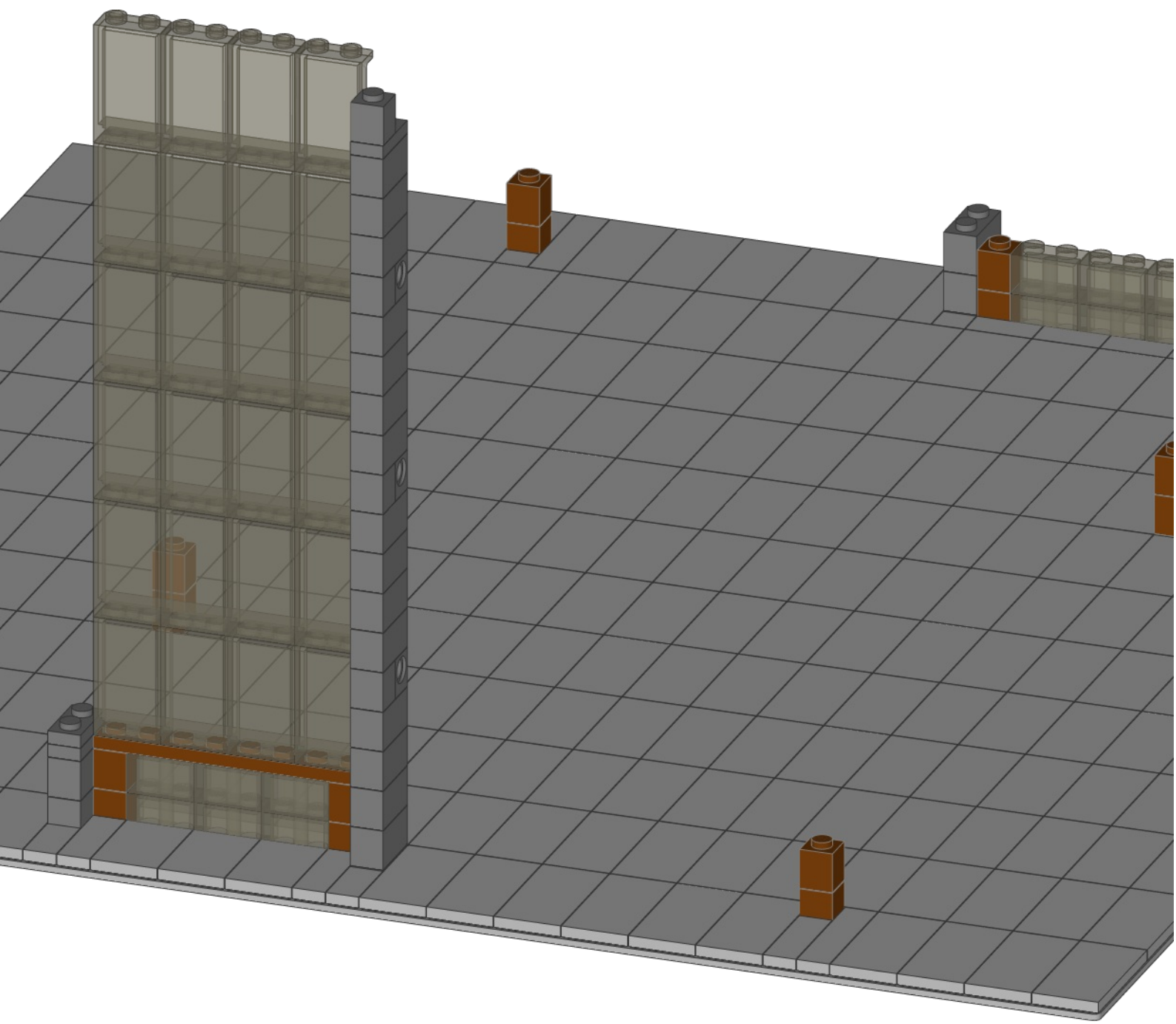

5

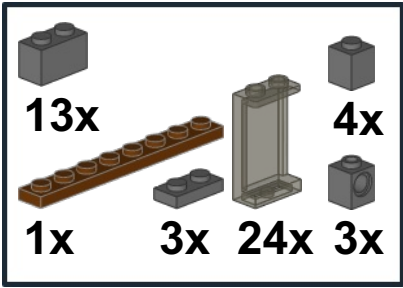

13x
1x
3x
24x
4x
3x



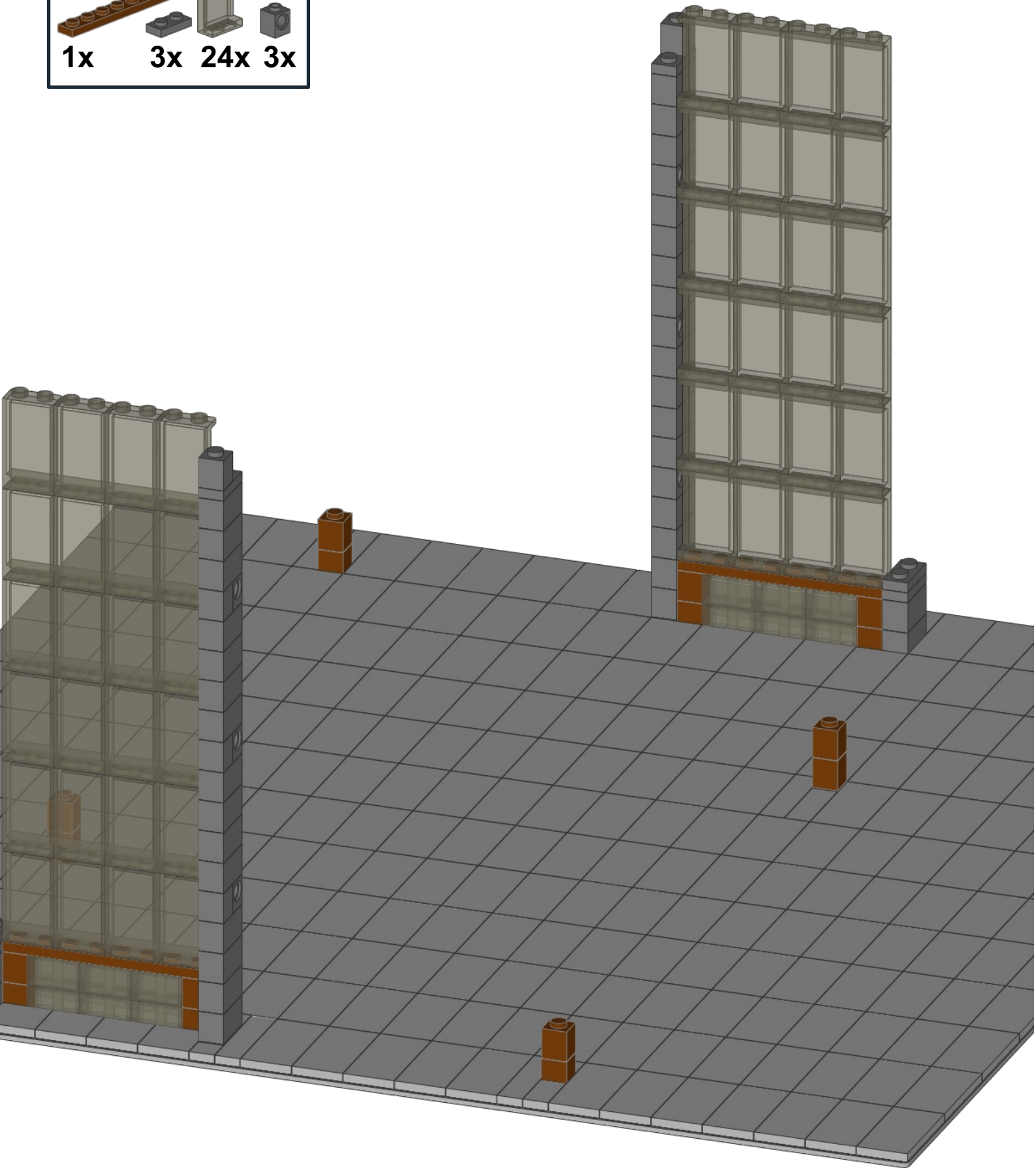

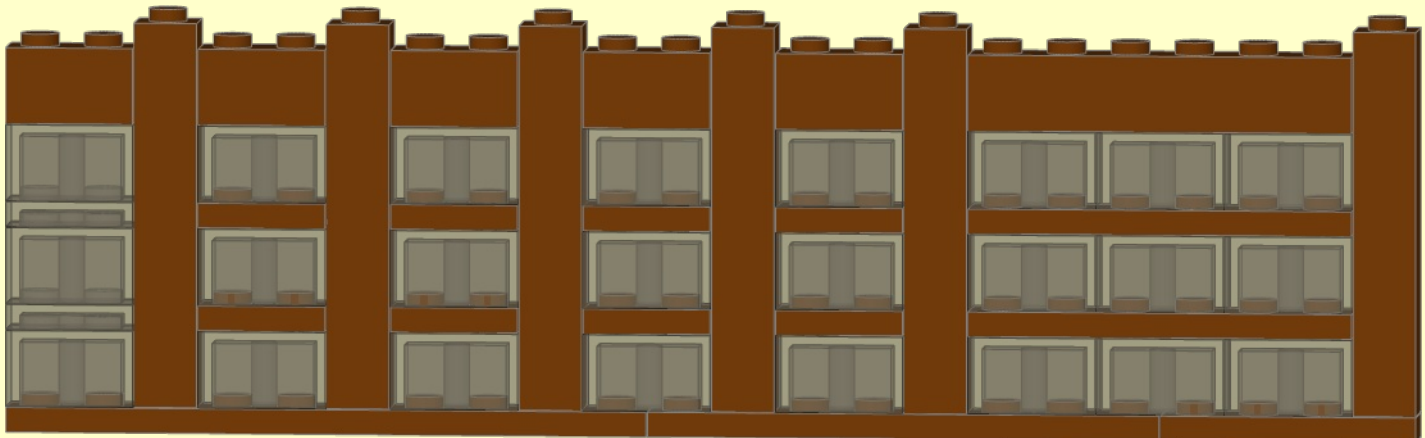
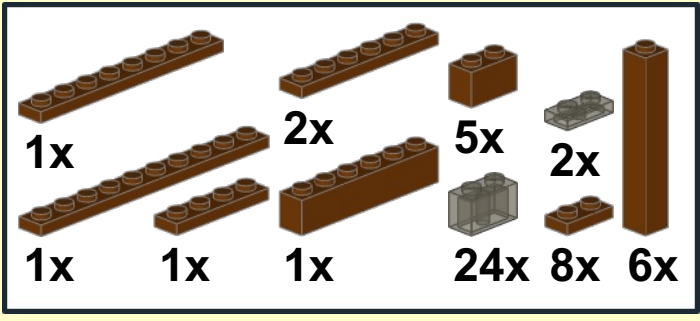

This block contains a list of LEGO parts with their respective quantities. The parts are: 13x grey 1x1 bricks, 1x brown 1x13 Technic beam, 3x grey 1x1 Technic pins, 24x grey 1x1 Technic pins, 4x grey 1x1 Technic pins, and 3x grey 1x1 Technic pins.



1



2

	
1x	4x
	
1x	18x
	
2x	2x
	
	24x

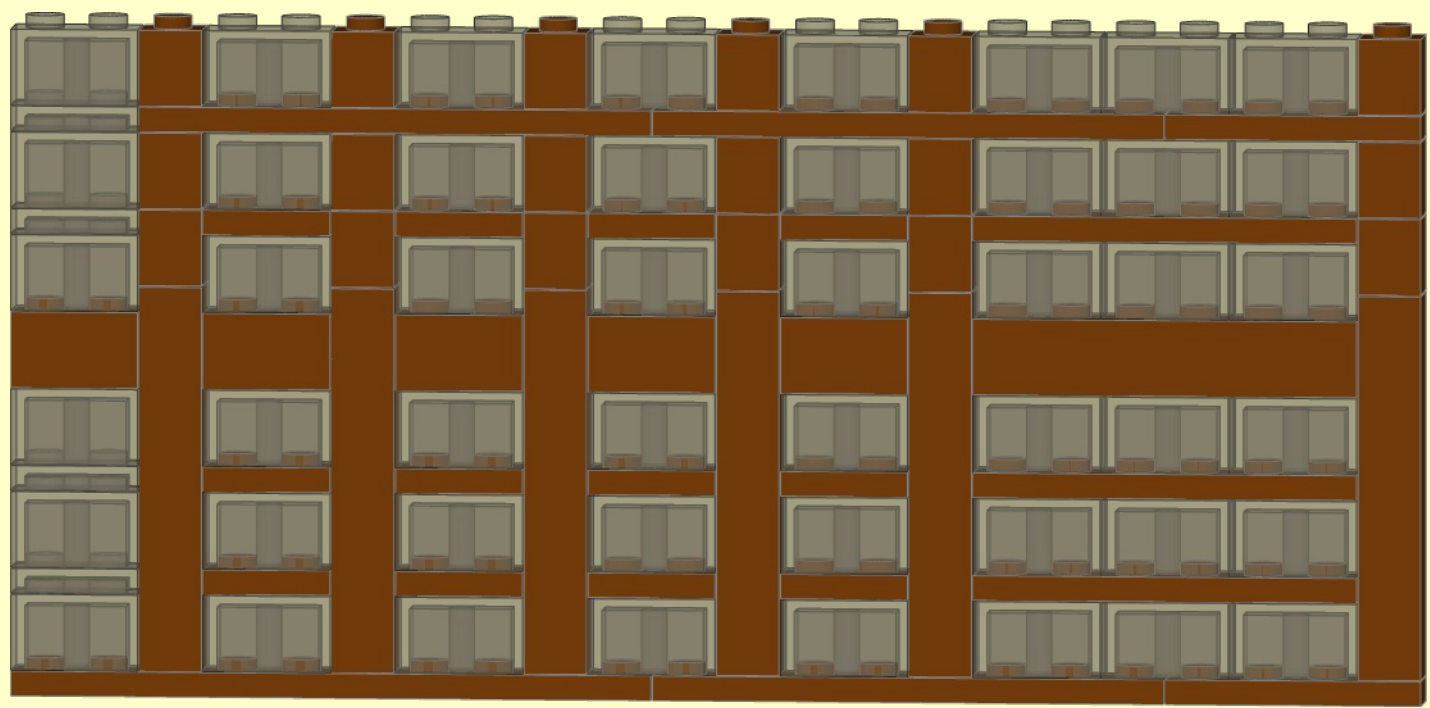

3

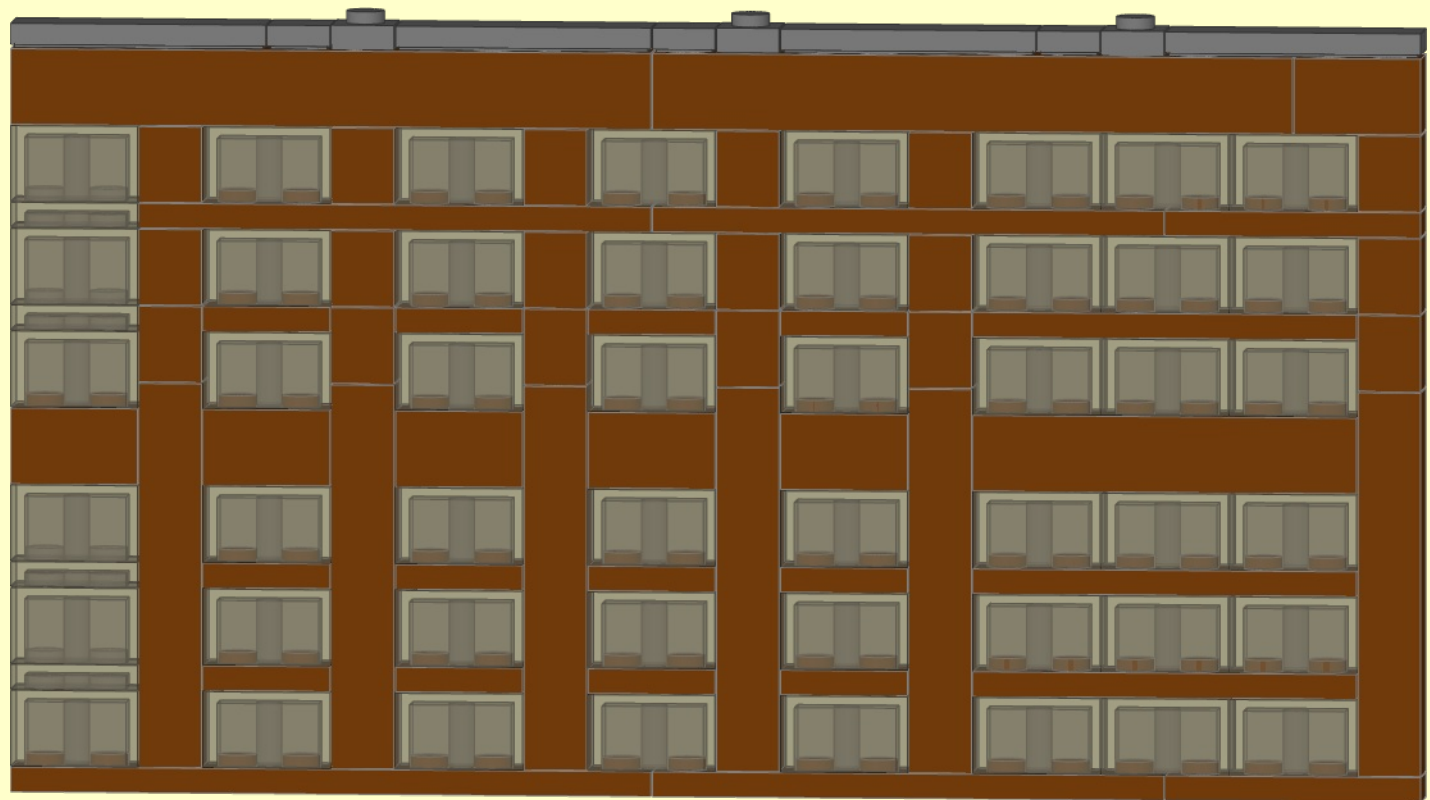
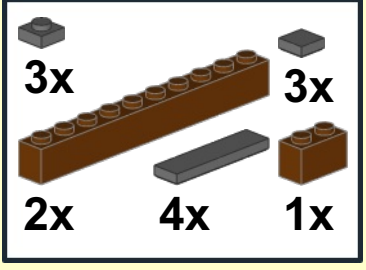



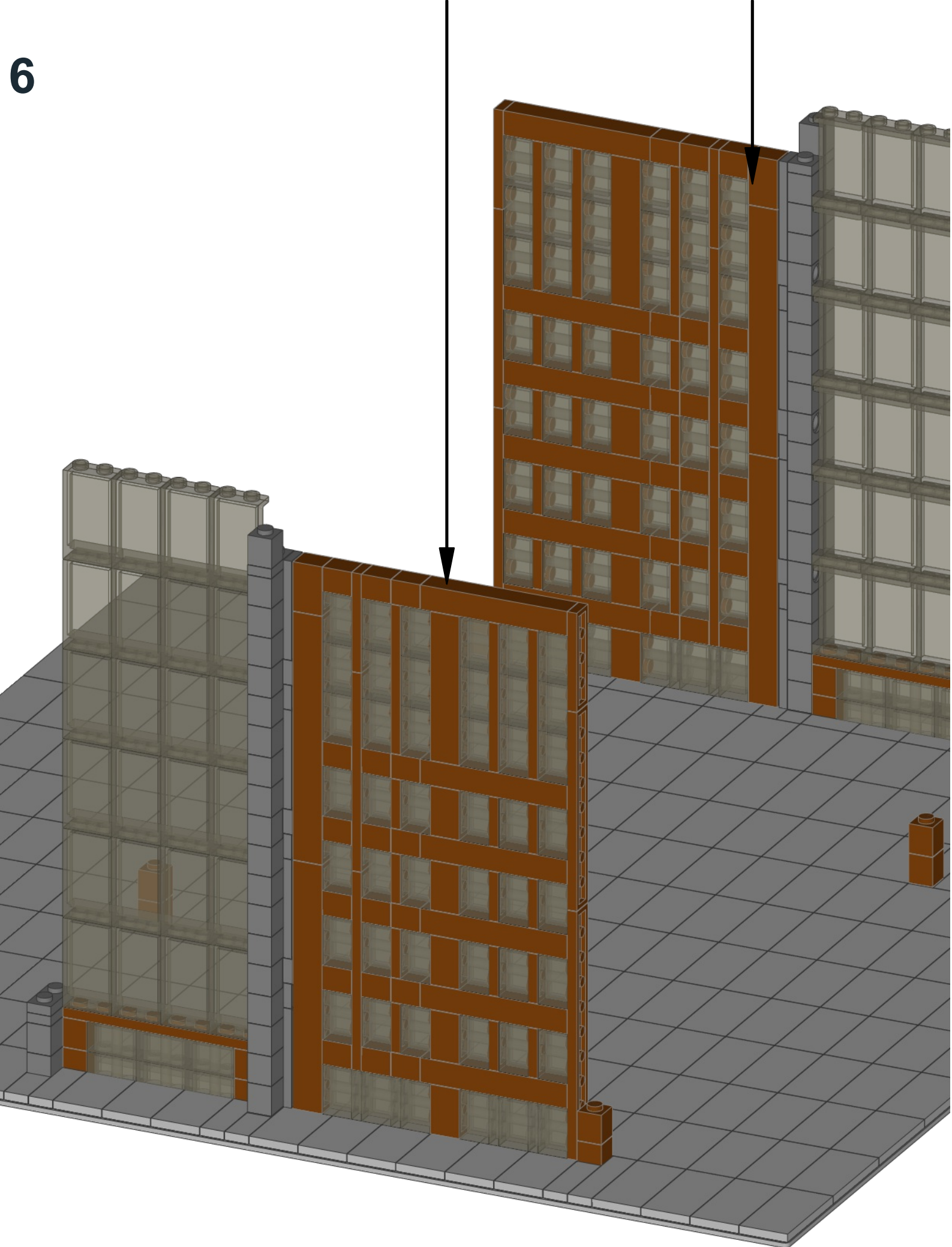

x2

6





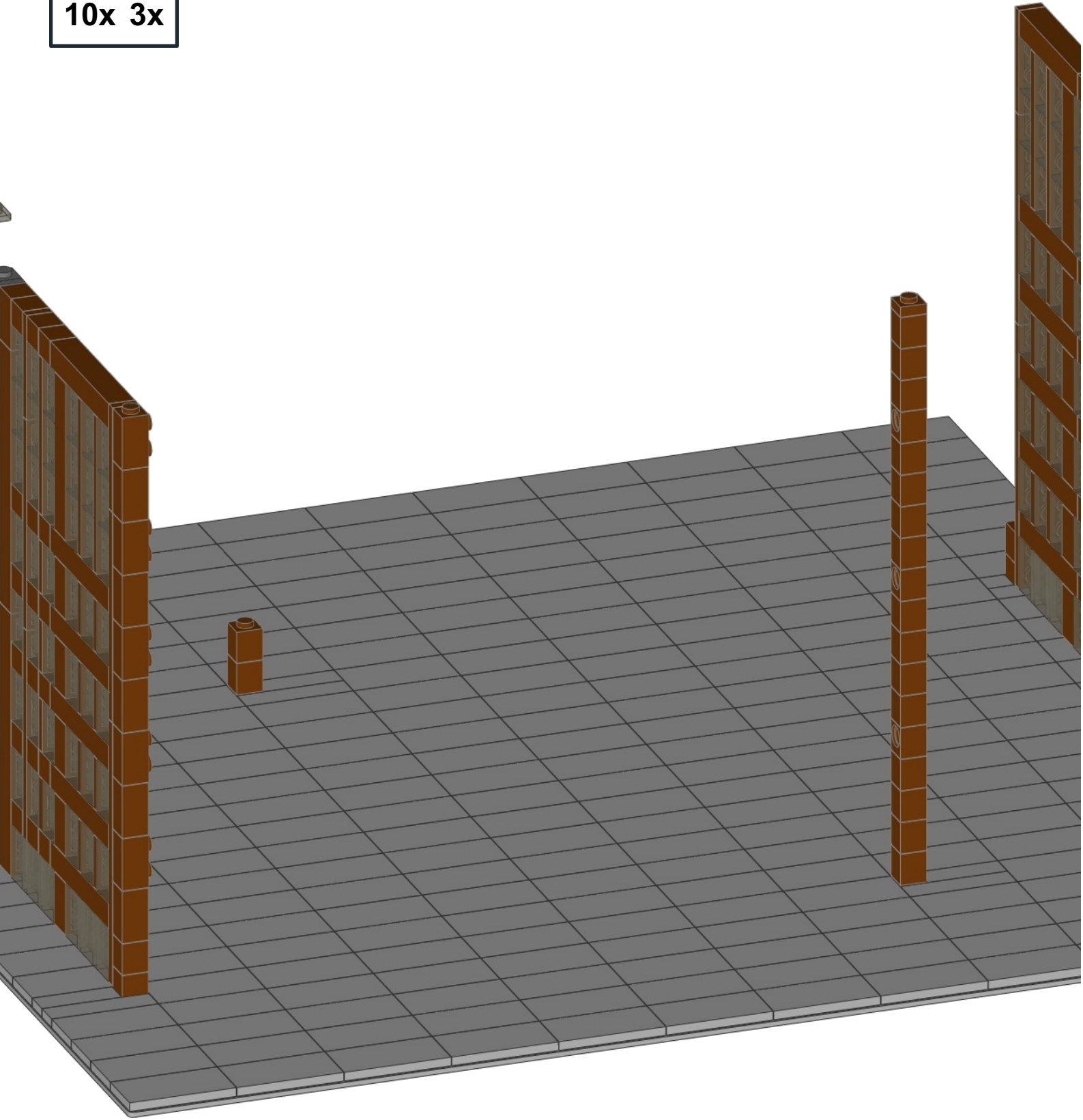

7

	
13x	1x
	
10x	3x



8

	
13x	1x
	
10x	3x

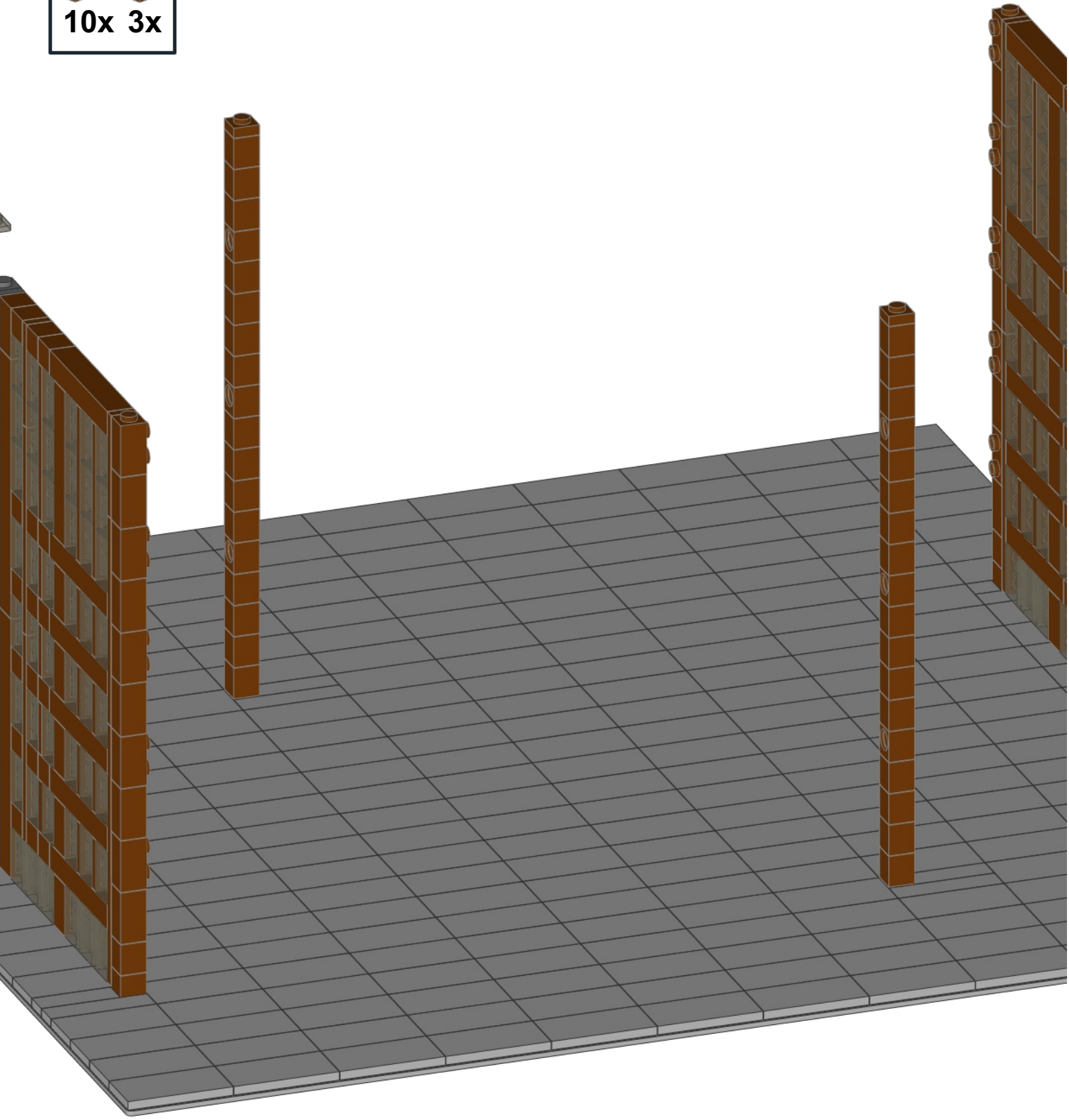

1

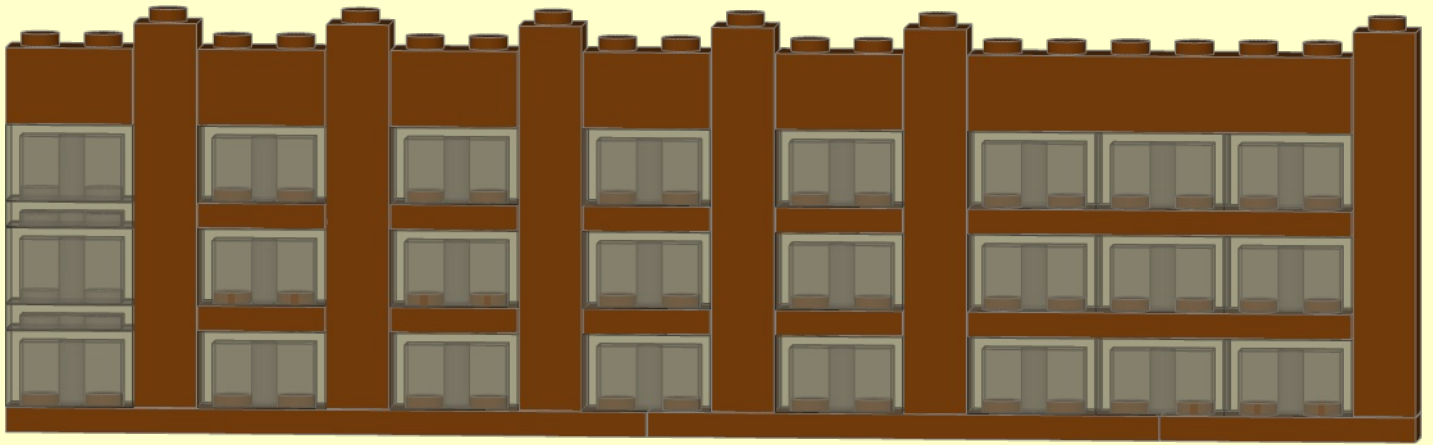
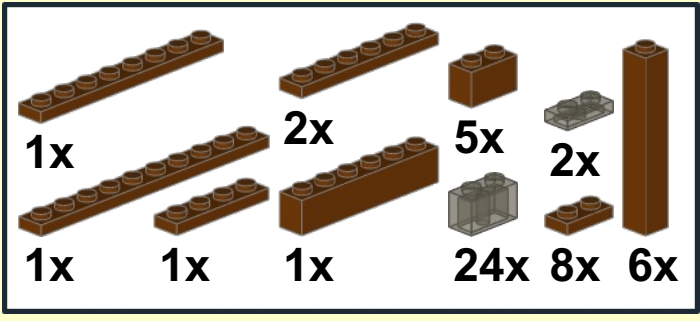

2

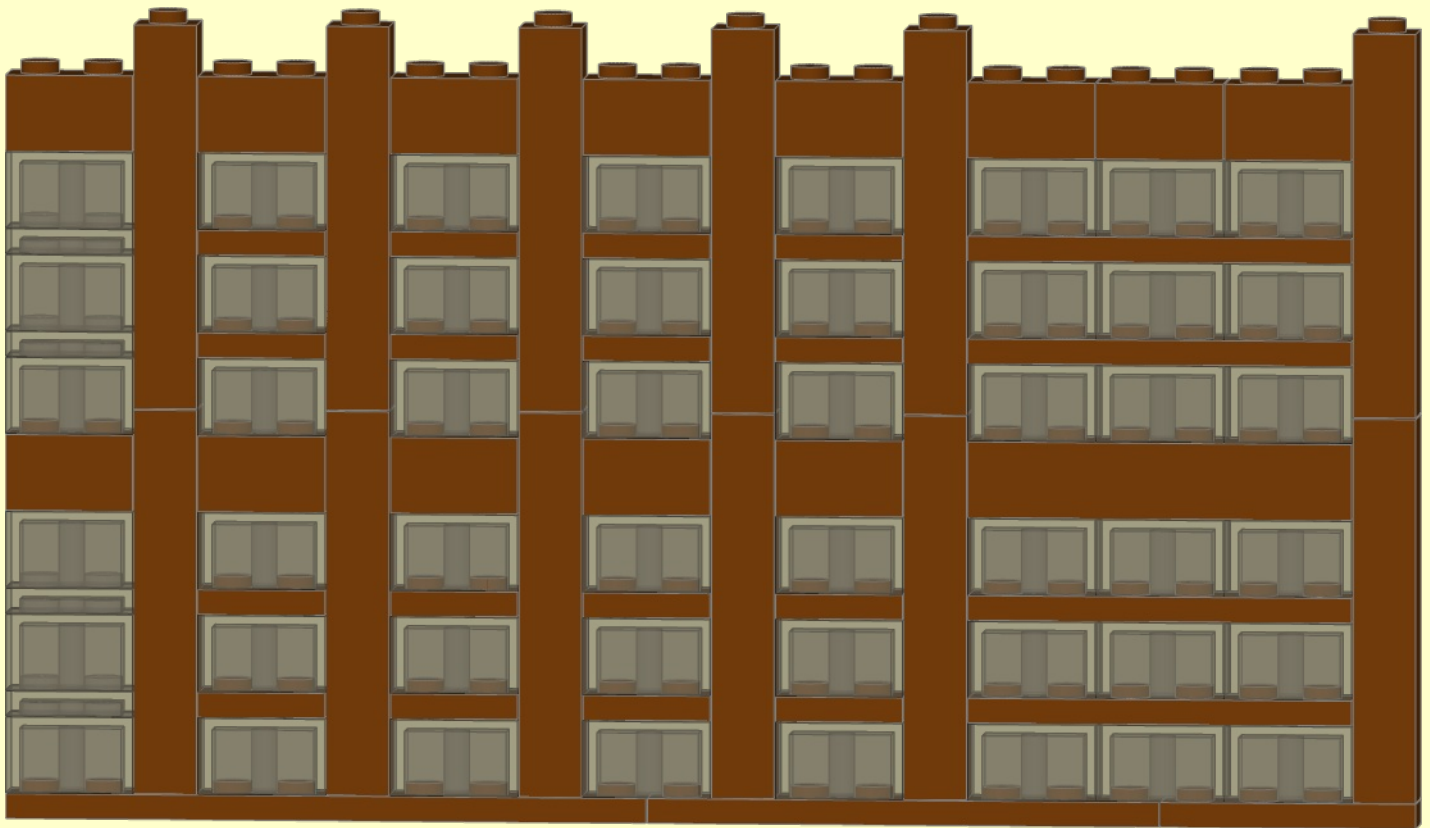
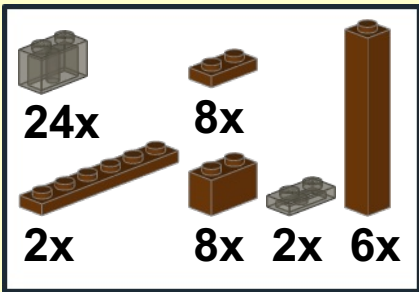

3

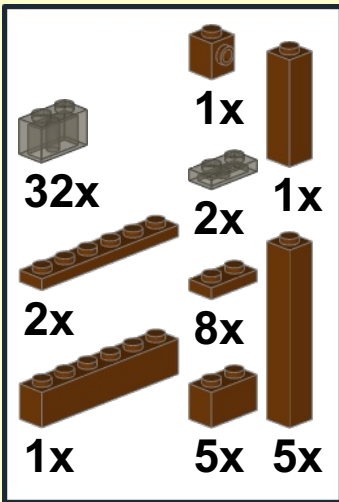

32x
2x
1x
1x
2x
1x
1x
1x
2x
8x
5x
5x
1x
1x

This block contains a list of LEGO parts and their quantities for step 3. The parts are arranged in three columns. The first column contains: 32x of a grey 1x1 window, 2x of a brown 1x5 Technic beam, and 1x of a brown 1x5 Technic beam. The second column contains: 1x of a brown 1x1 Technic brick with a hole, 2x of a grey 1x2 Technic plate, 2x of a brown 1x2 Technic brick with a hole, 8x of a brown 1x2 Technic brick with a hole, and 5x of a brown 1x2 Technic brick with a hole. The third column contains: 1x of a brown 1x5 Technic beam, 1x of a brown 1x5 Technic beam, and 5x of a brown 1x5 Technic beam.

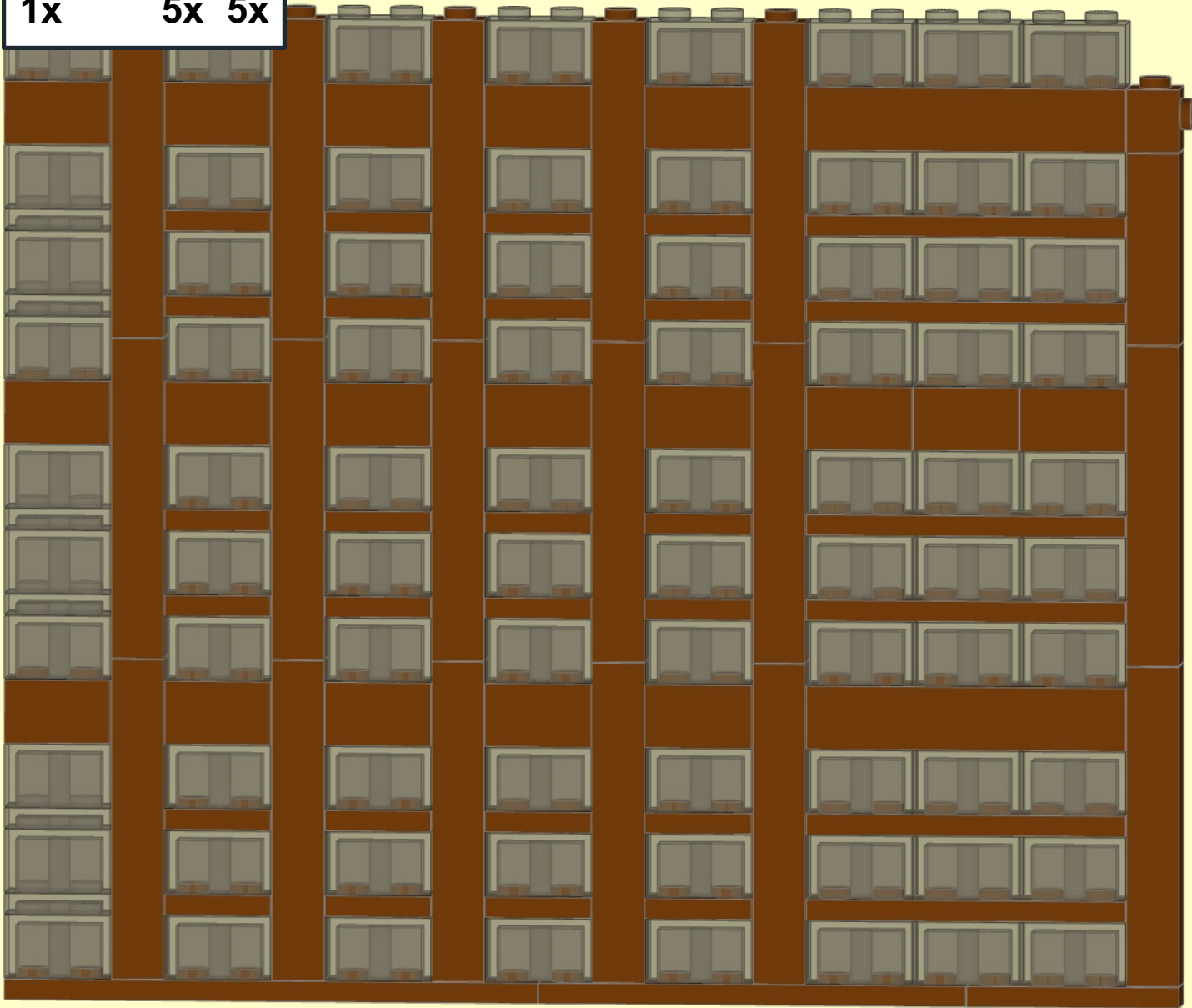

4

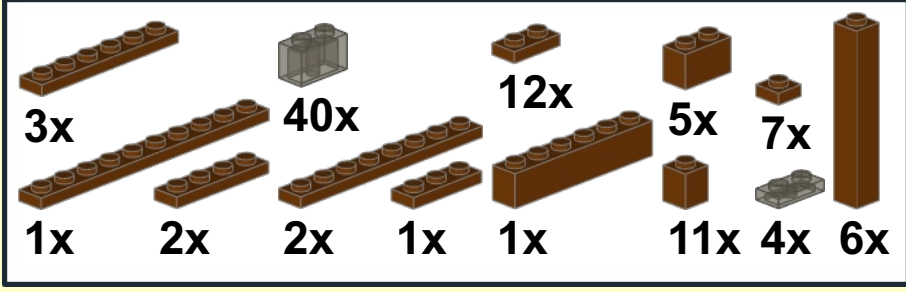



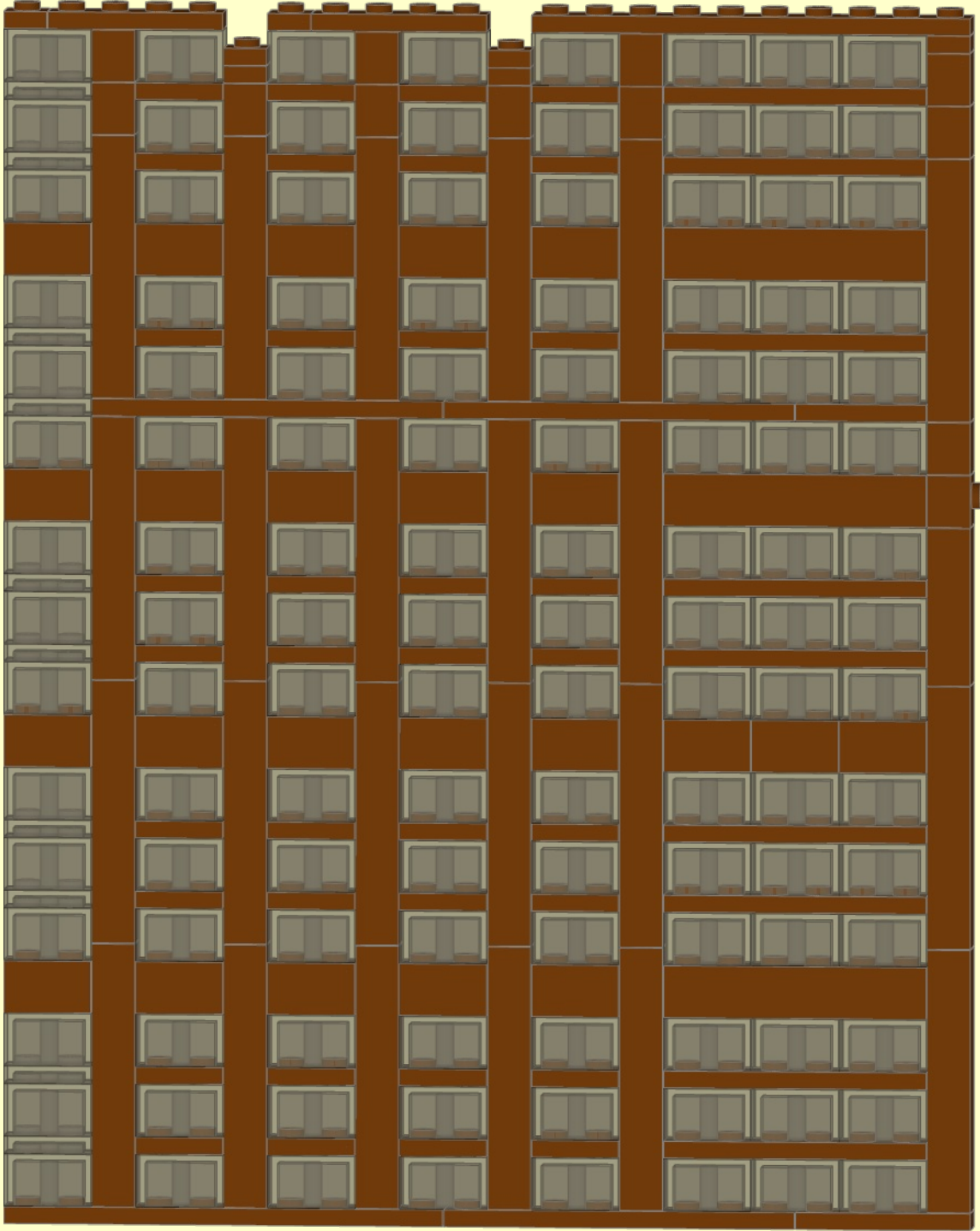

3x
1x
2x
2x
1x
1x
12x
5x
11x
40x
7x
6x

Detailed description: A list of LEGO parts for step 4. The parts are arranged in two rows. The top row shows: a 1x5 Technic brick (3x), a 1x4 Technic brick with a hole (40x), a 1x2 Technic brick (12x), a 1x2 Technic brick (5x), a 1x1 Technic brick (7x), and a 1x6 Technic brick (6x). The bottom row shows: a 1x1 Technic brick (1x), a 1x2 Technic brick (2x), a 1x4 Technic brick with a hole (2x), a 1x2 Technic brick (1x), a 1x5 Technic brick (1x), a 1x1 Technic brick (11x), a 1x1 Technic brick with a hole (4x), and a 1x6 Technic brick (6x).



5

	
1x	3x
	
4x	2x

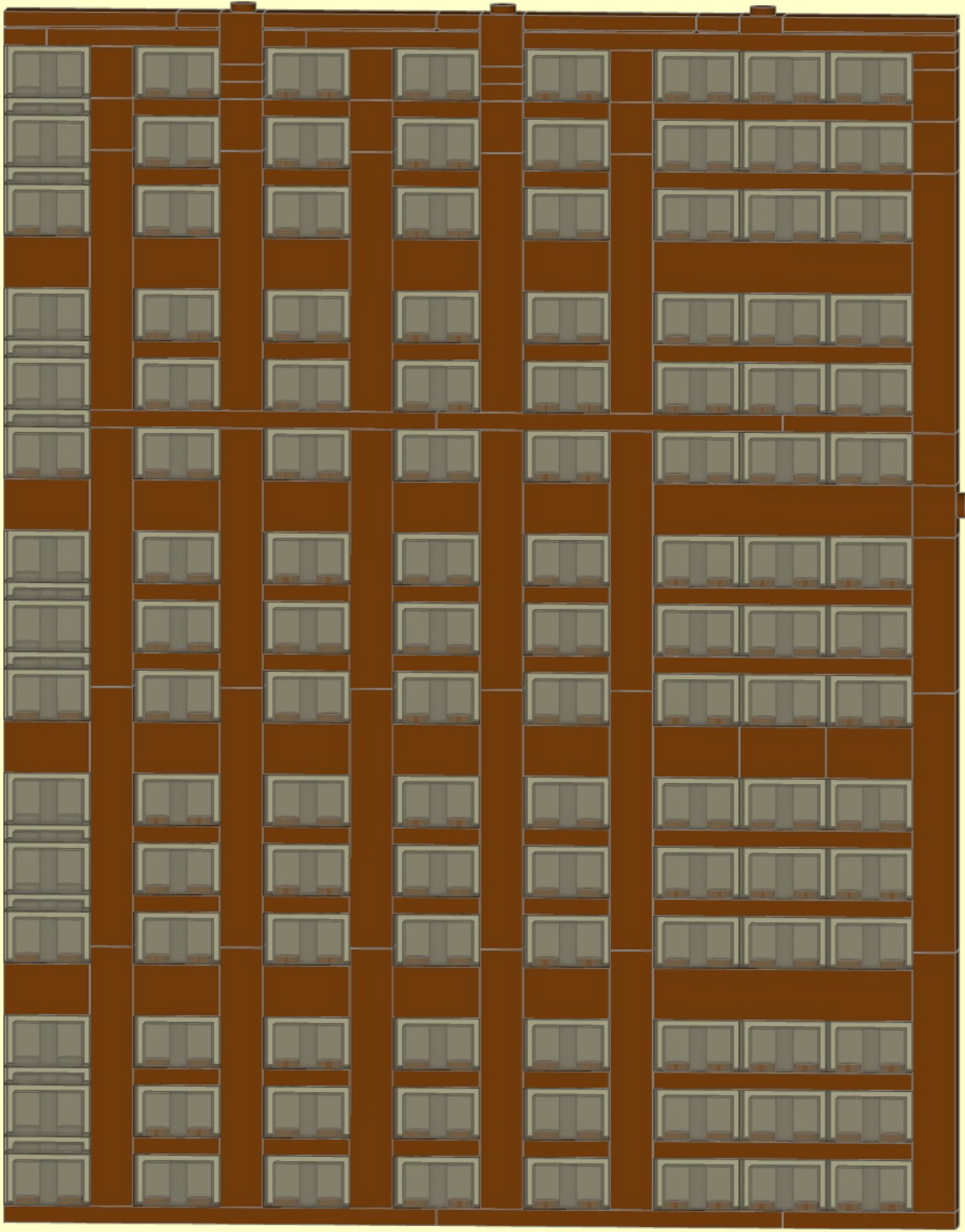

x2

9

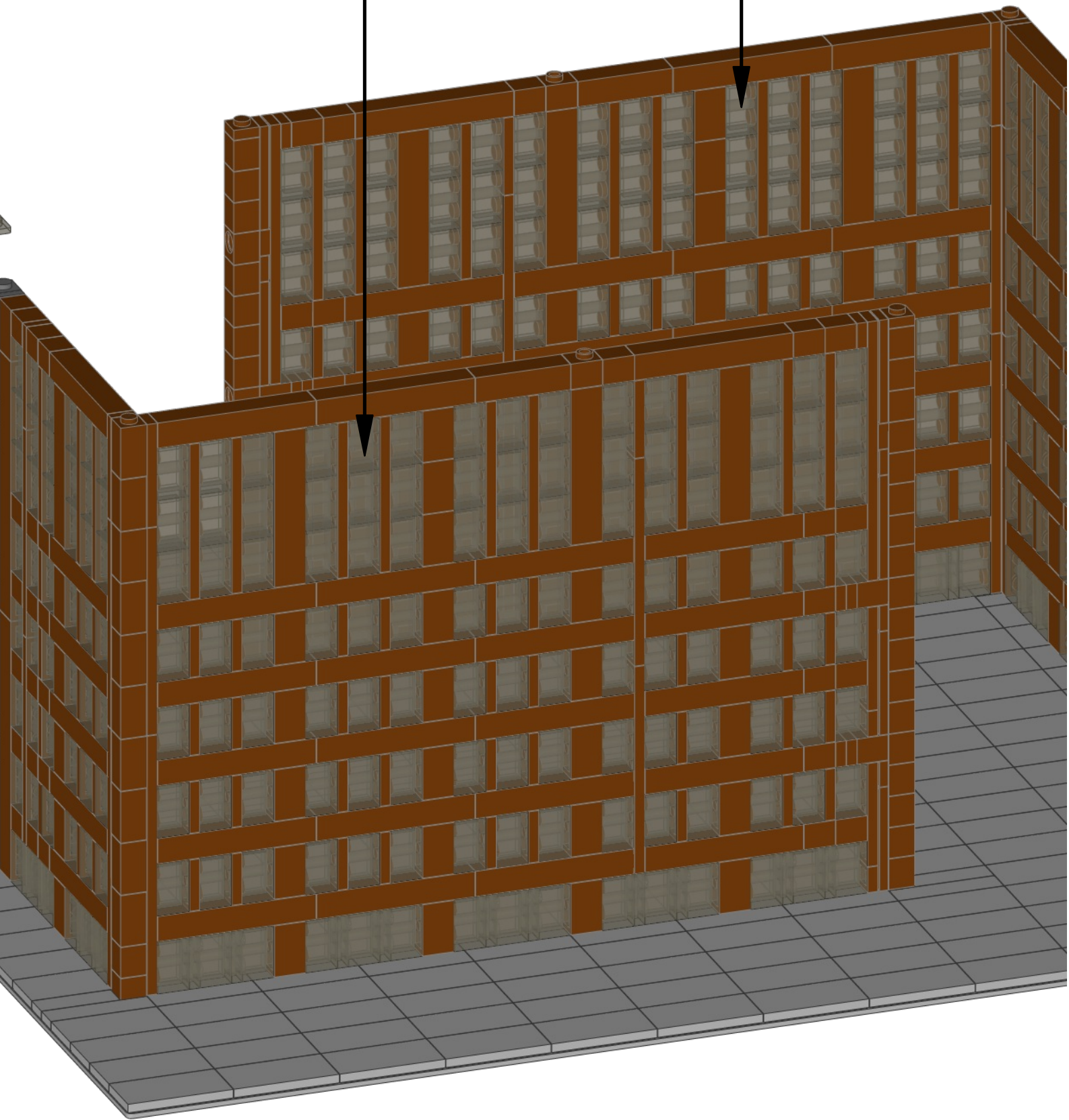

1

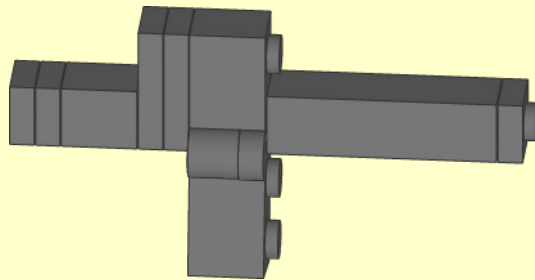
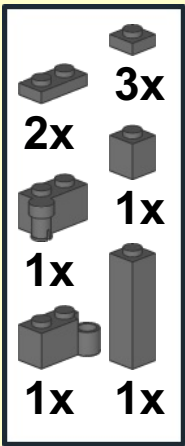

2

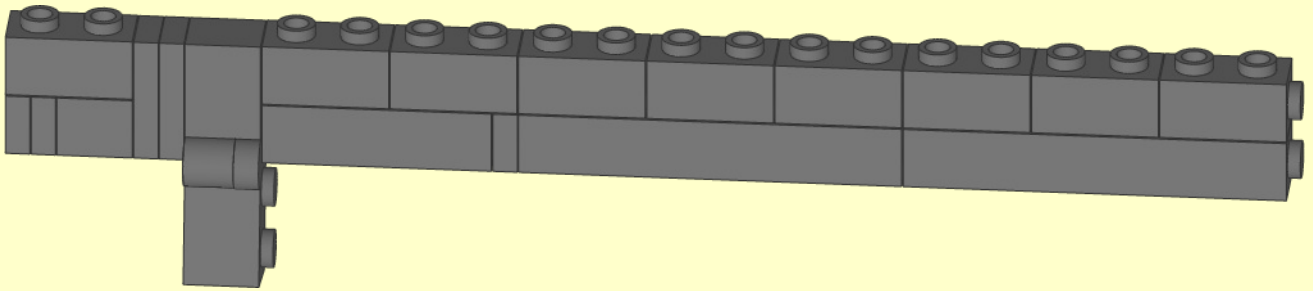
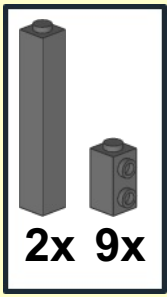

3



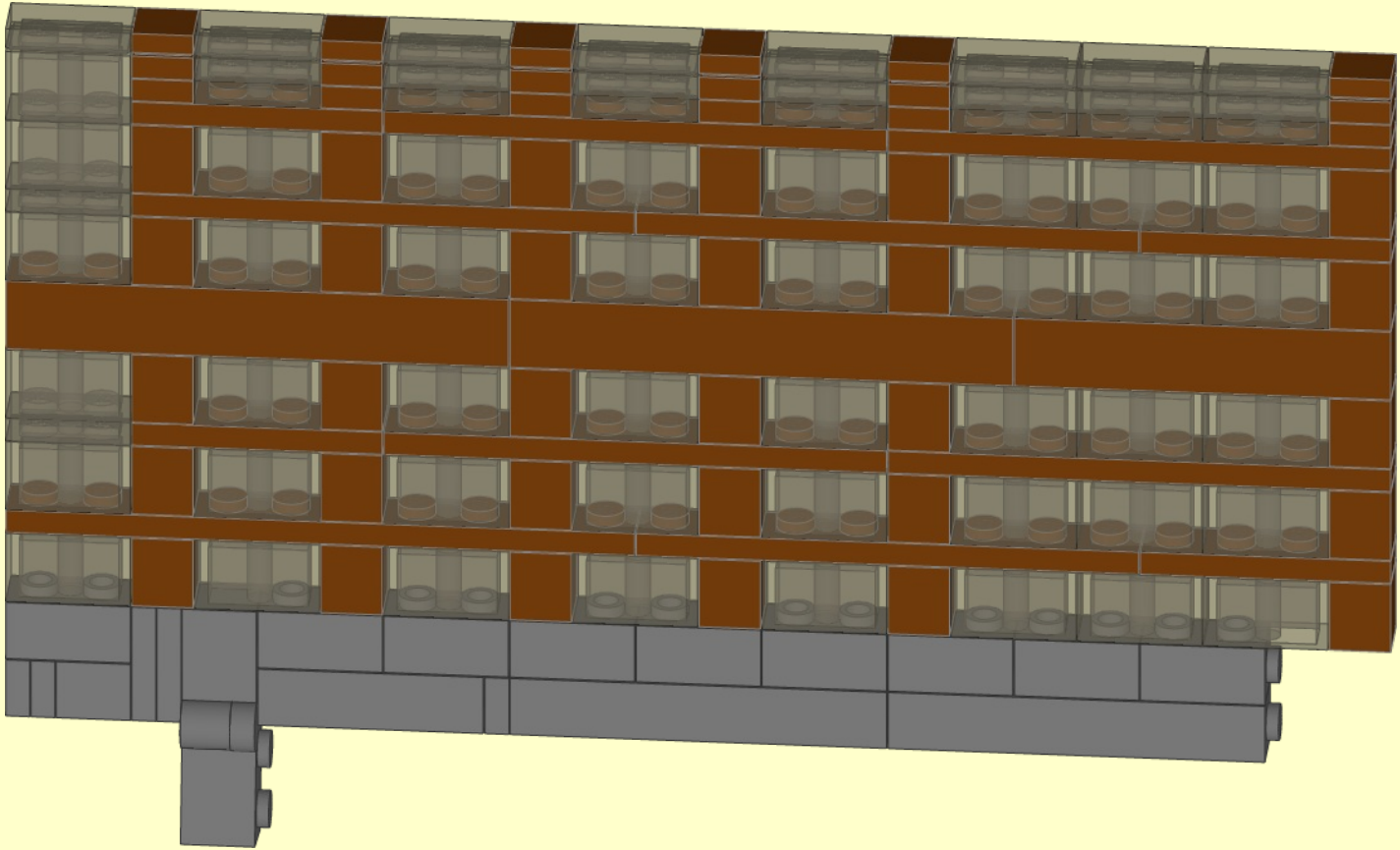



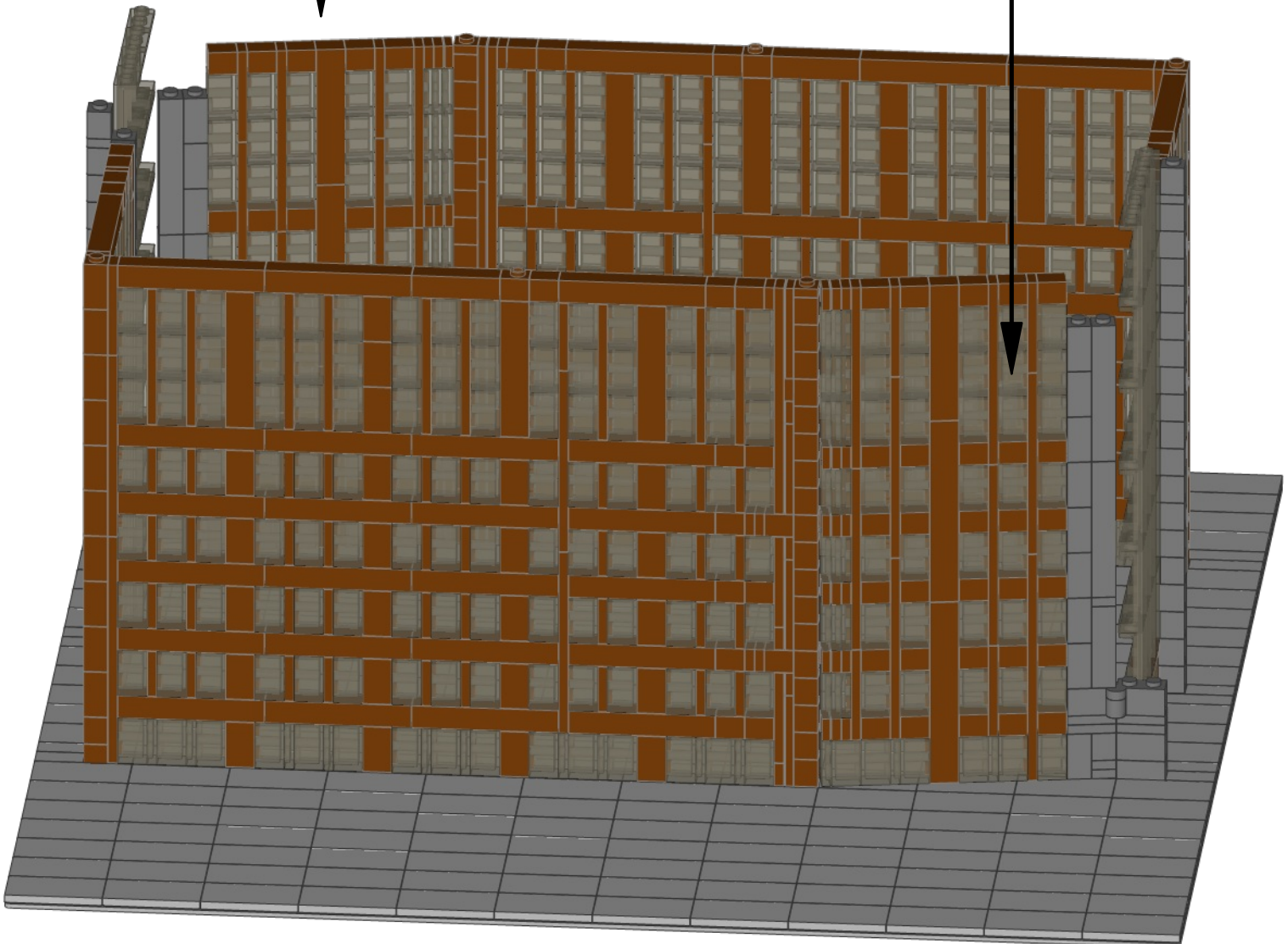



2x (1x5 brown brick)
 1x (1x7 brown brick)
 4x (1x3 brown brick)
 7x (1x5 brown brick)
 16x (1x2 grey brick)
 41x (1x2 grey brick)
 12x (1x1 brown brick)
 6x (1x1 brown brick)
 30x (1x2 grey brick)
 8x (1x1 brown brick)



10

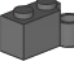

11

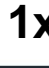

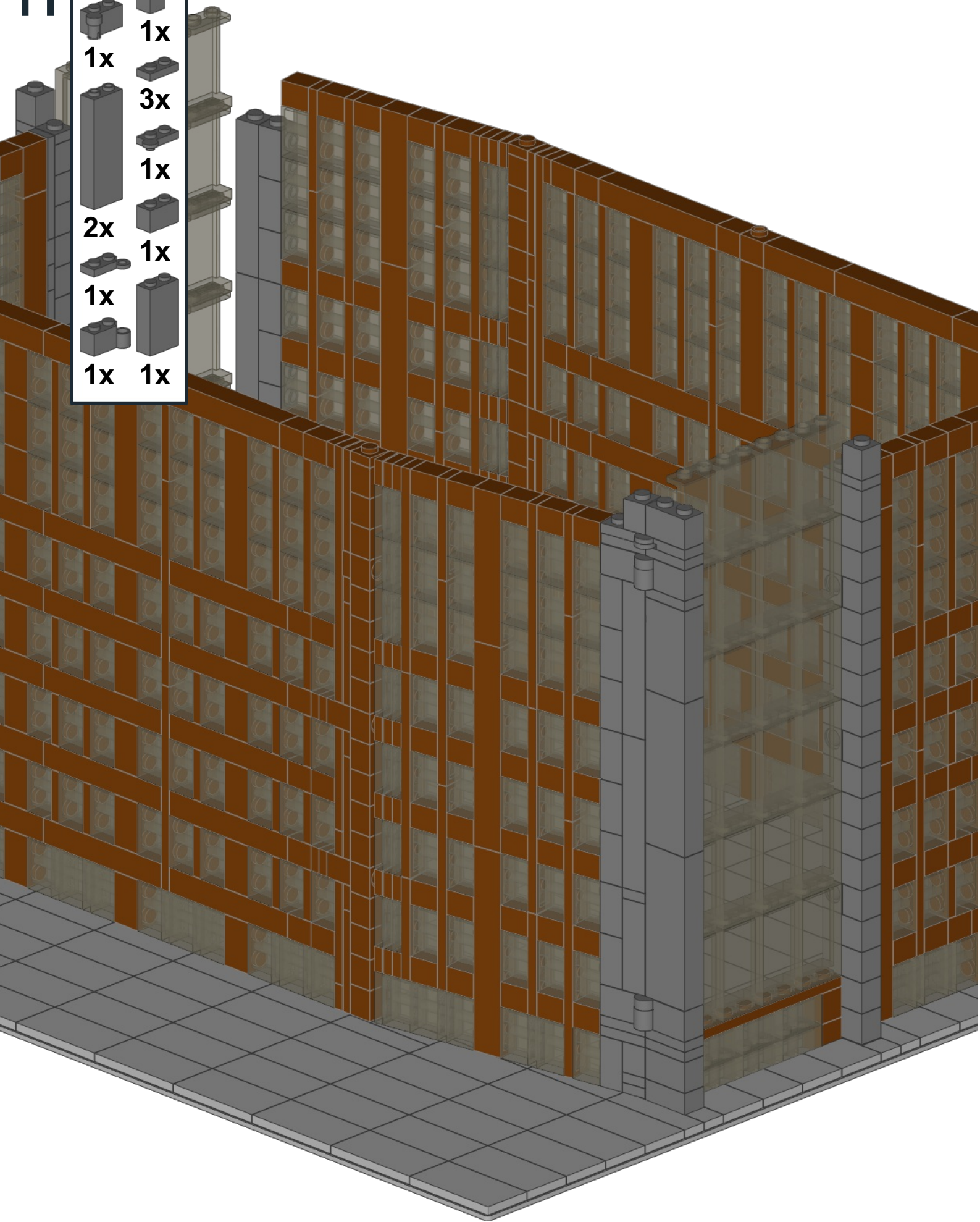



- | | | |
|---|---|----|
|  |  | 1x |
| 1x |  | 3x |
|  |  | 1x |
| 2x |  | 1x |
|  |  | 1x |
|  |  | 1x |
| 1x |  | 1x |

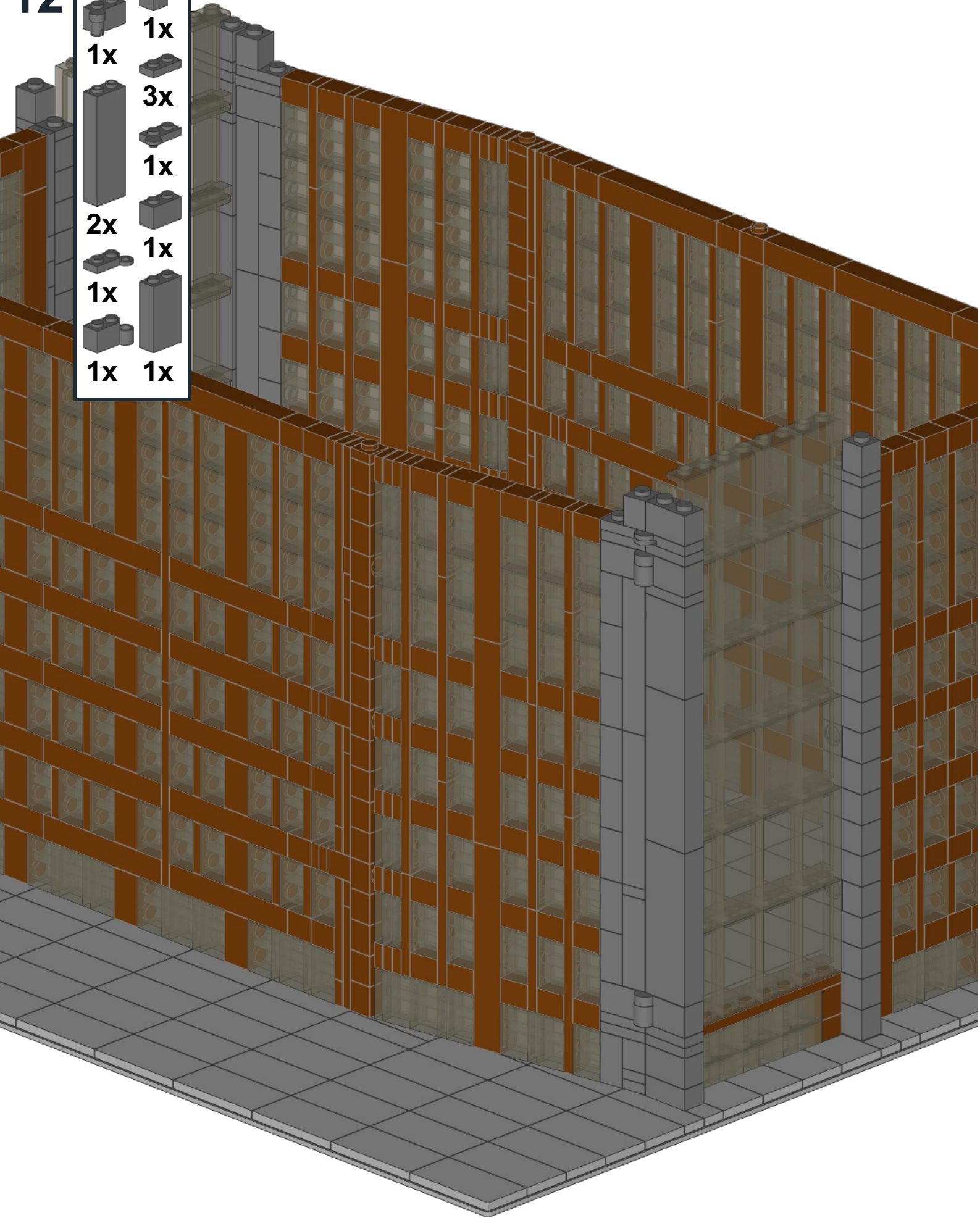

12

- 1x 1x1 grey brick with hole
- 1x 1x1 grey brick
- 1x 1x2 grey brick
- 3x 1x2 grey brick
- 1x 1x2 grey brick with hole
- 1x 1x2 grey brick
- 2x 1x2 grey brick
- 1x 1x2 grey brick
- 1x 1x2 grey brick with hole
- 1x 1x2 grey brick
- 1x 1x2 grey brick
- 1x 1x2 grey brick



	
1x	3x
	
10x	1x
	
15x	4x

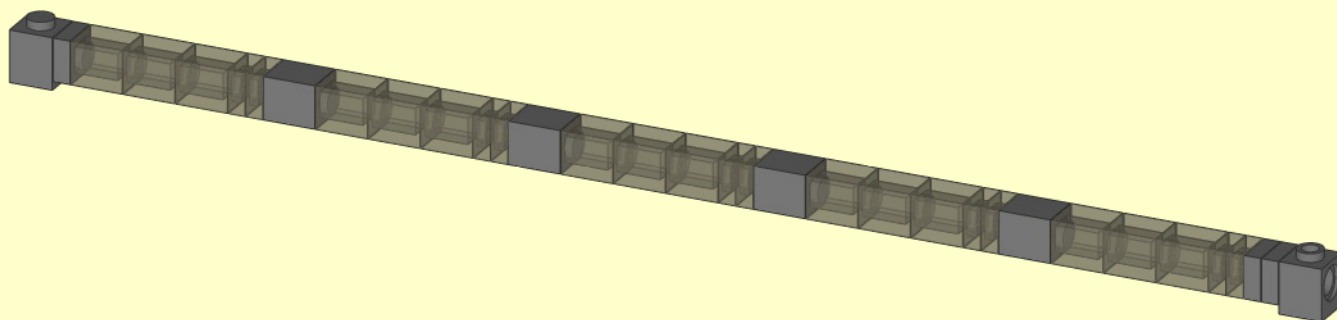

x2

13

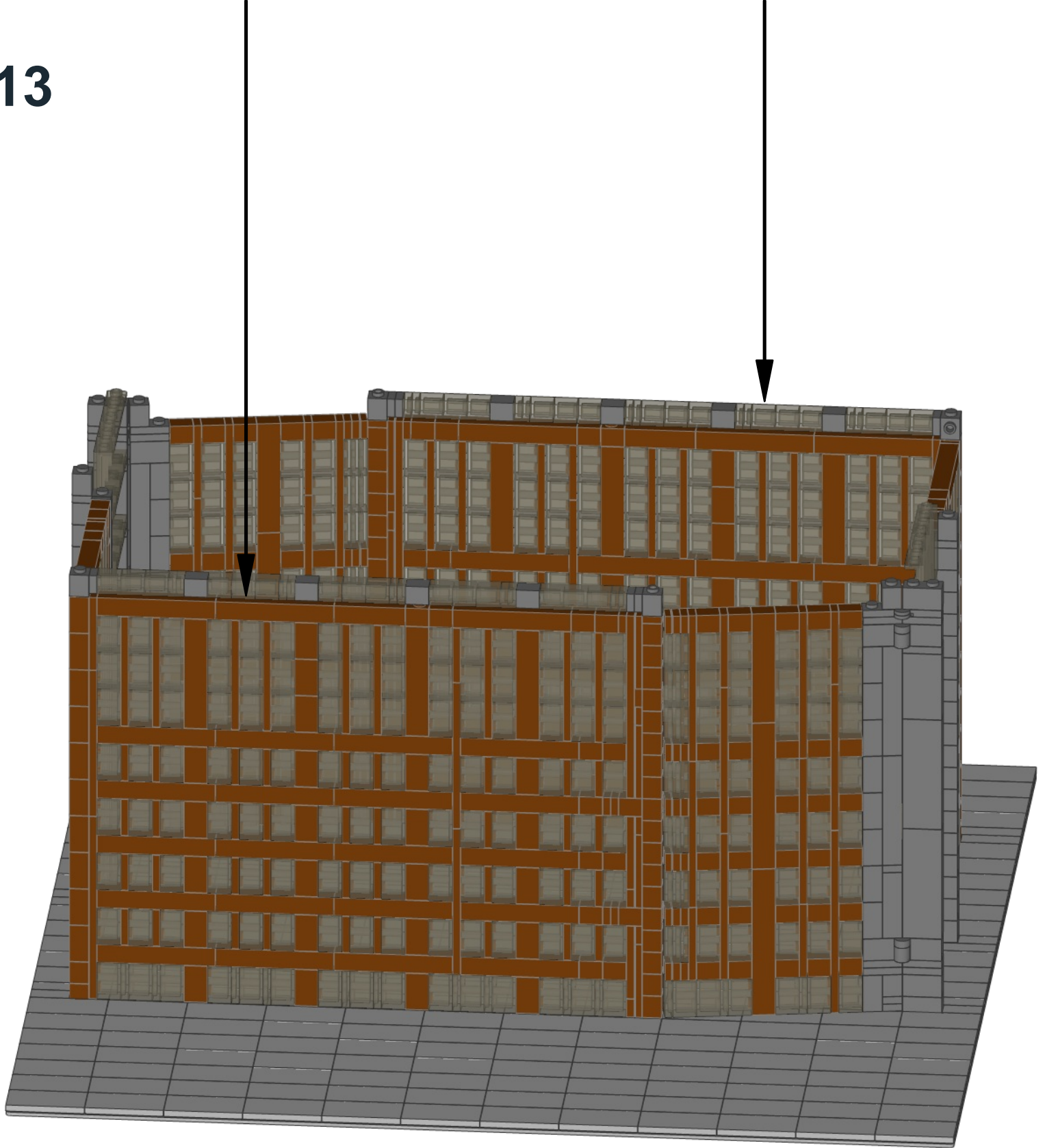

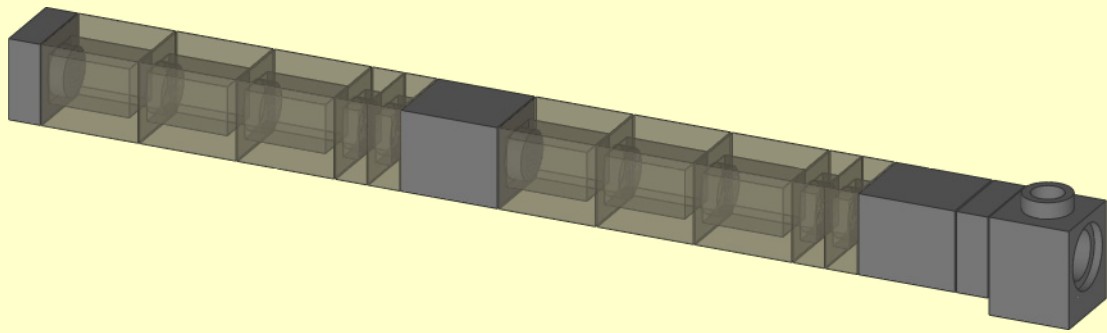

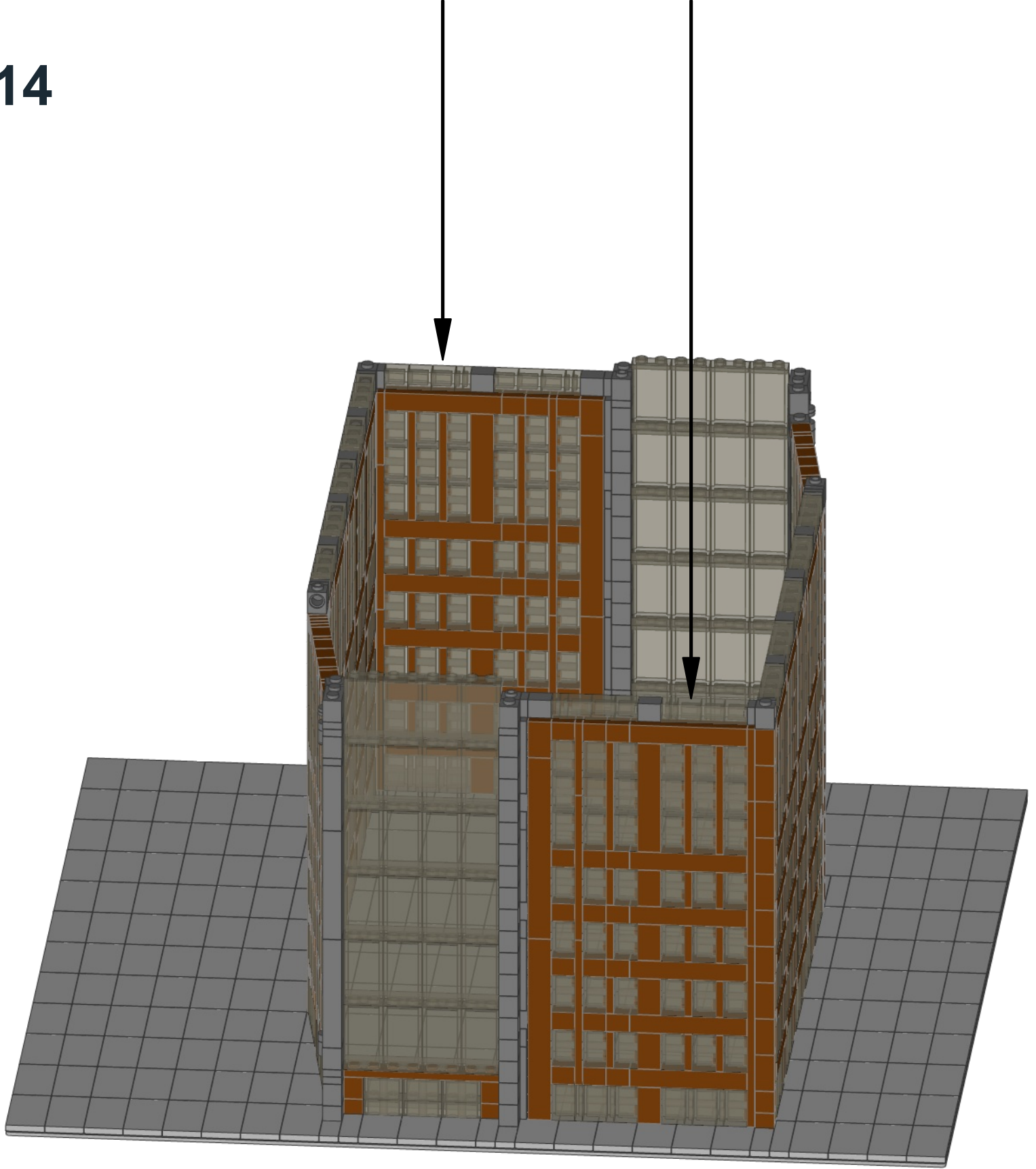

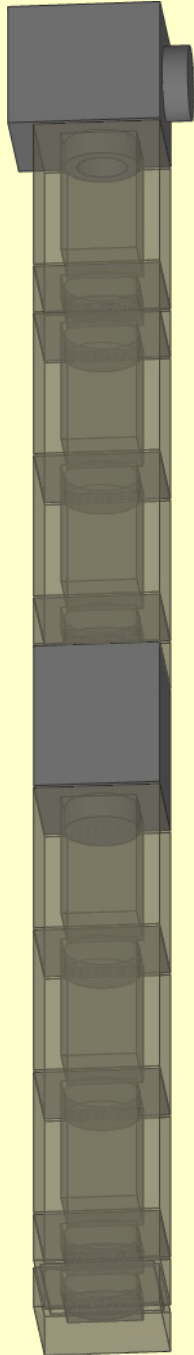
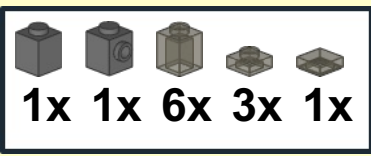

x2

15

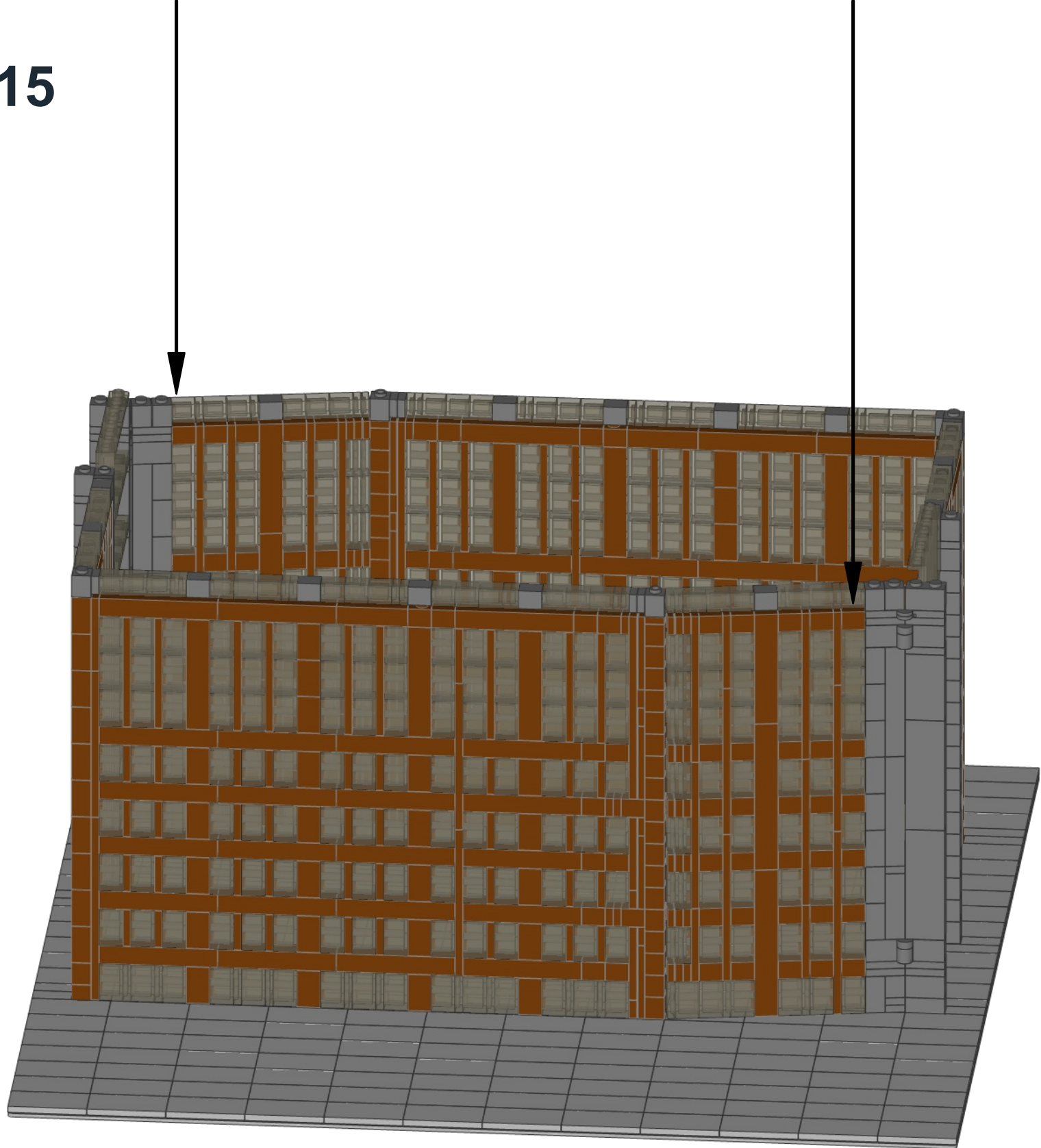

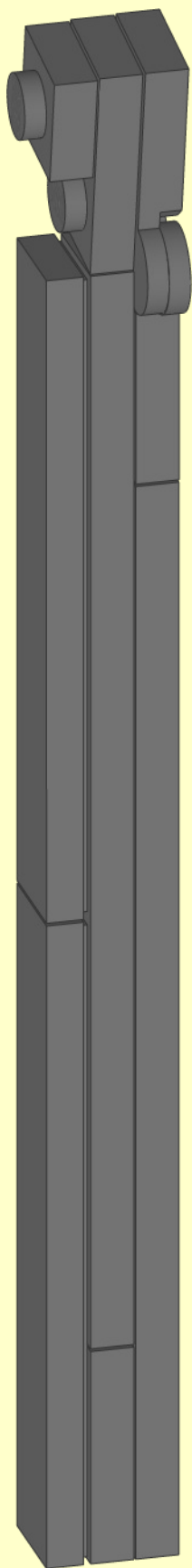
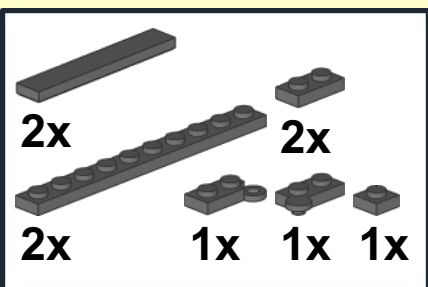

x2

16

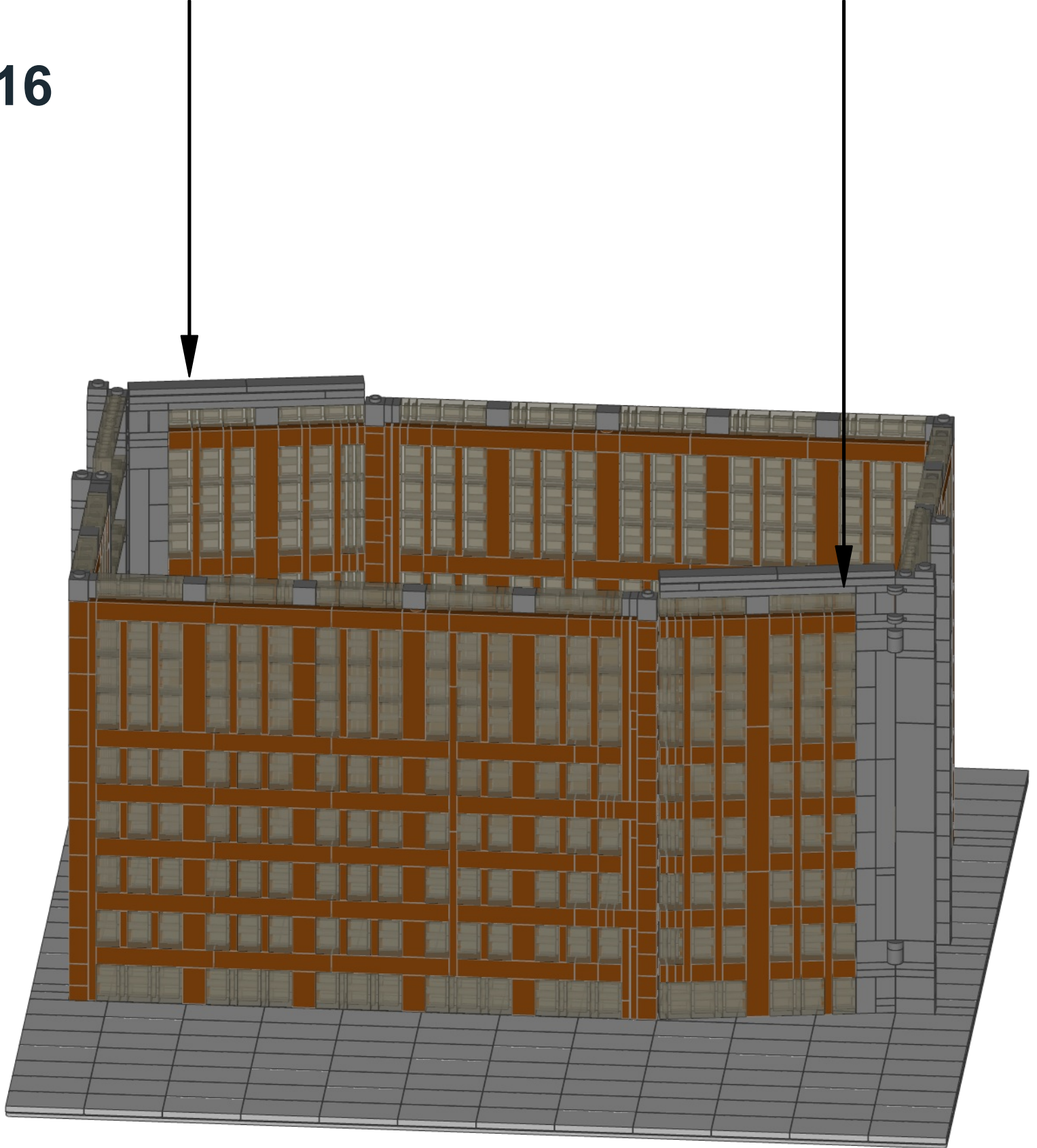

1

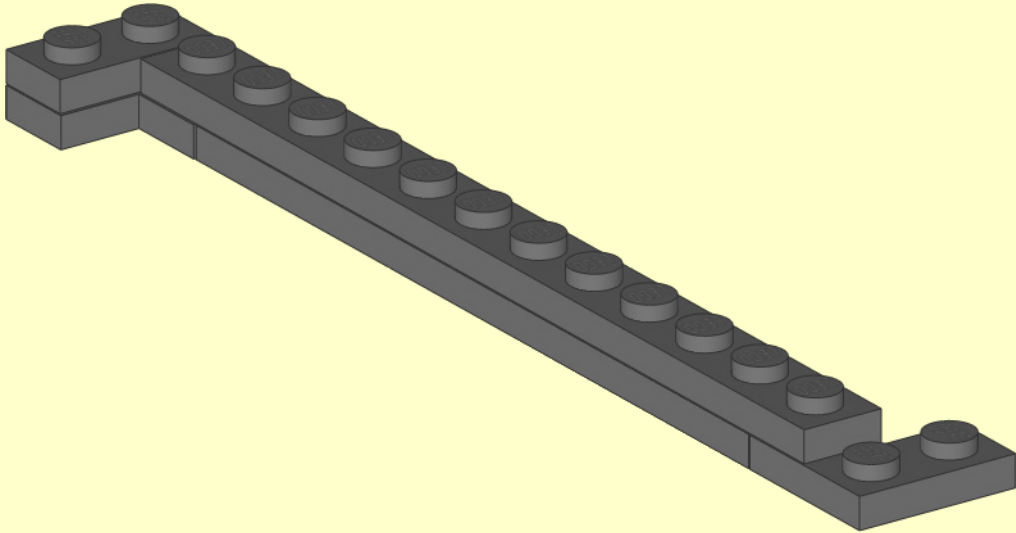
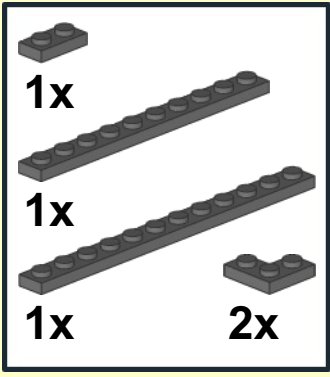

2

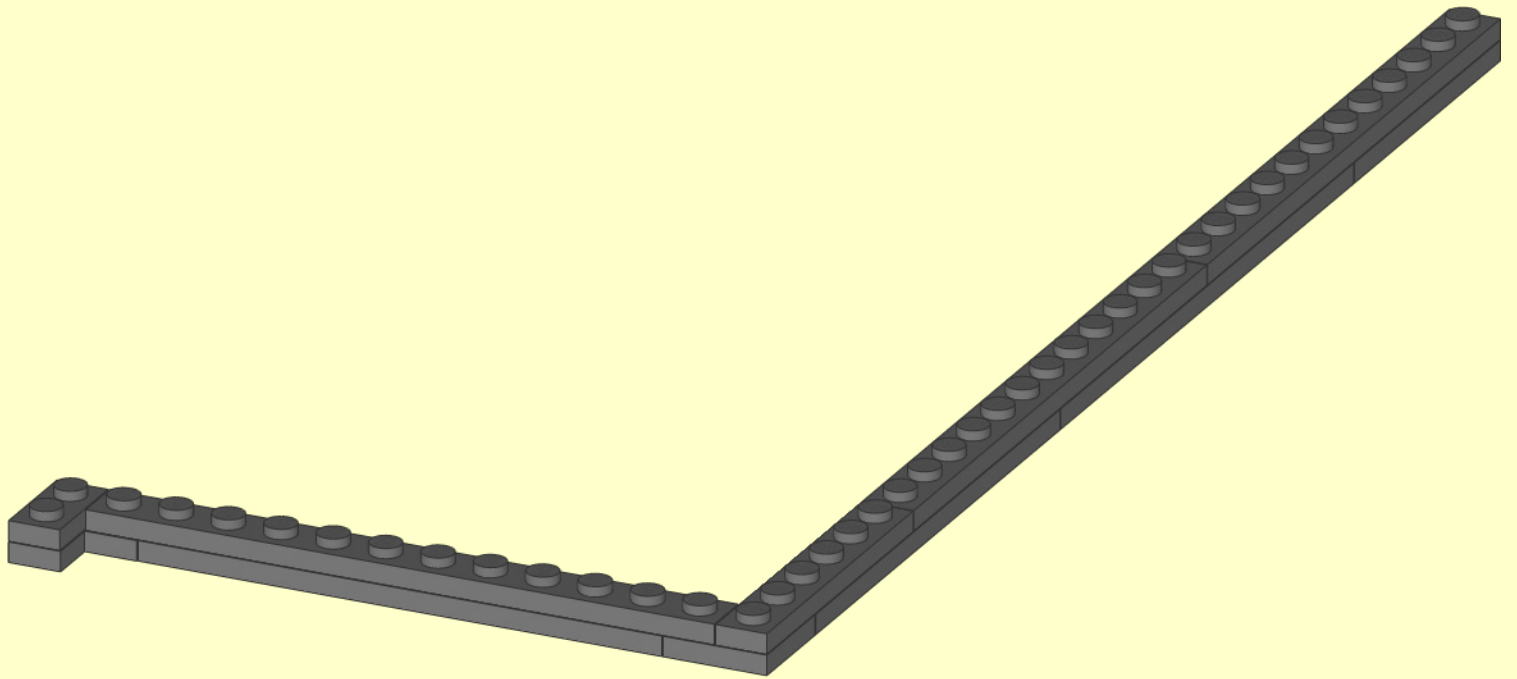
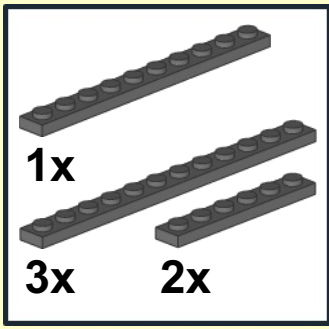

3

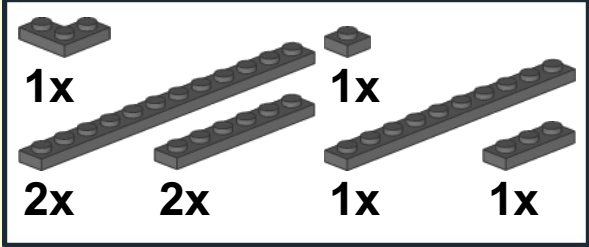

1x
2x
2x
1x
1x

1x
1x

Detailed description: A parts list for step 3. It shows a 1x2 L-shaped brick (1x), two 1x7 Technic bricks (2x), two 1x3 Technic bricks (2x), one 1x7 Technic brick (1x), one 1x3 Technic brick (1x), one 1x1 Technic brick (1x), and one 1x3 Technic brick (1x).

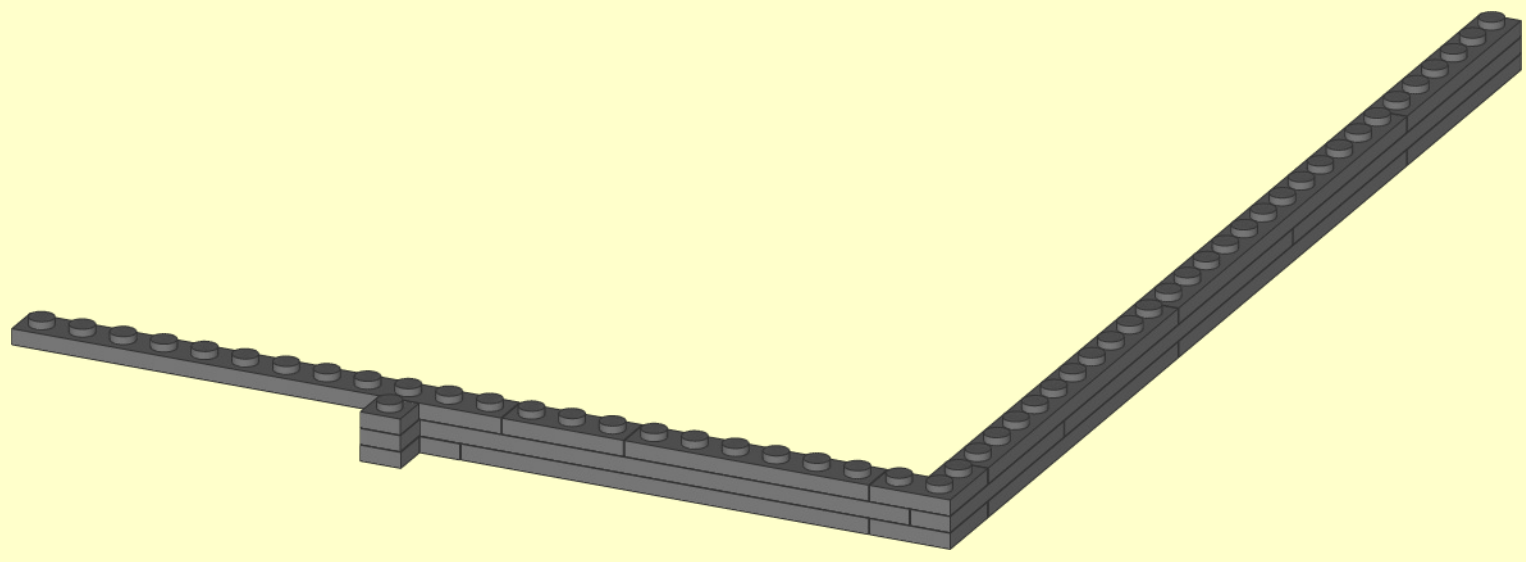

x2

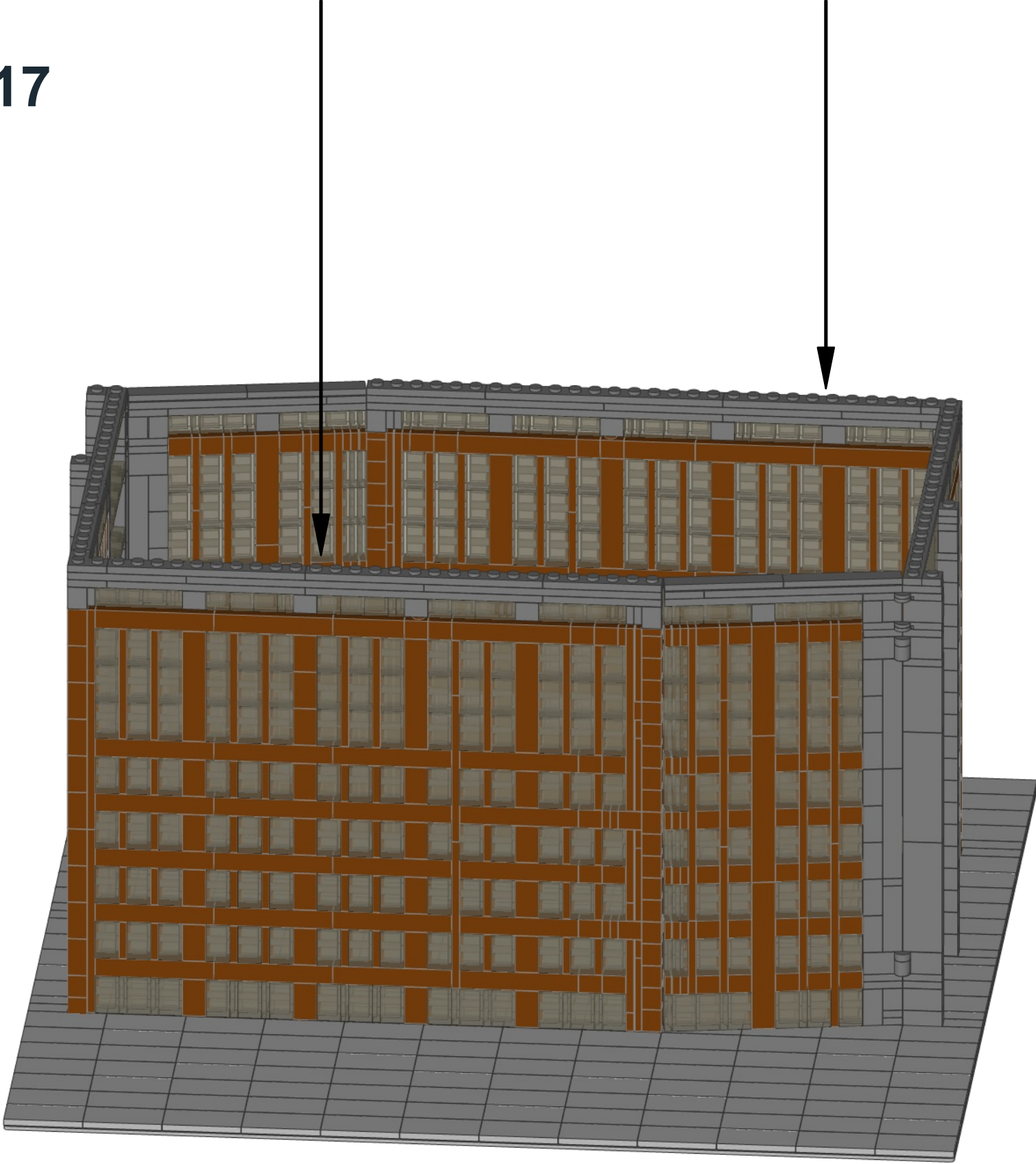

18

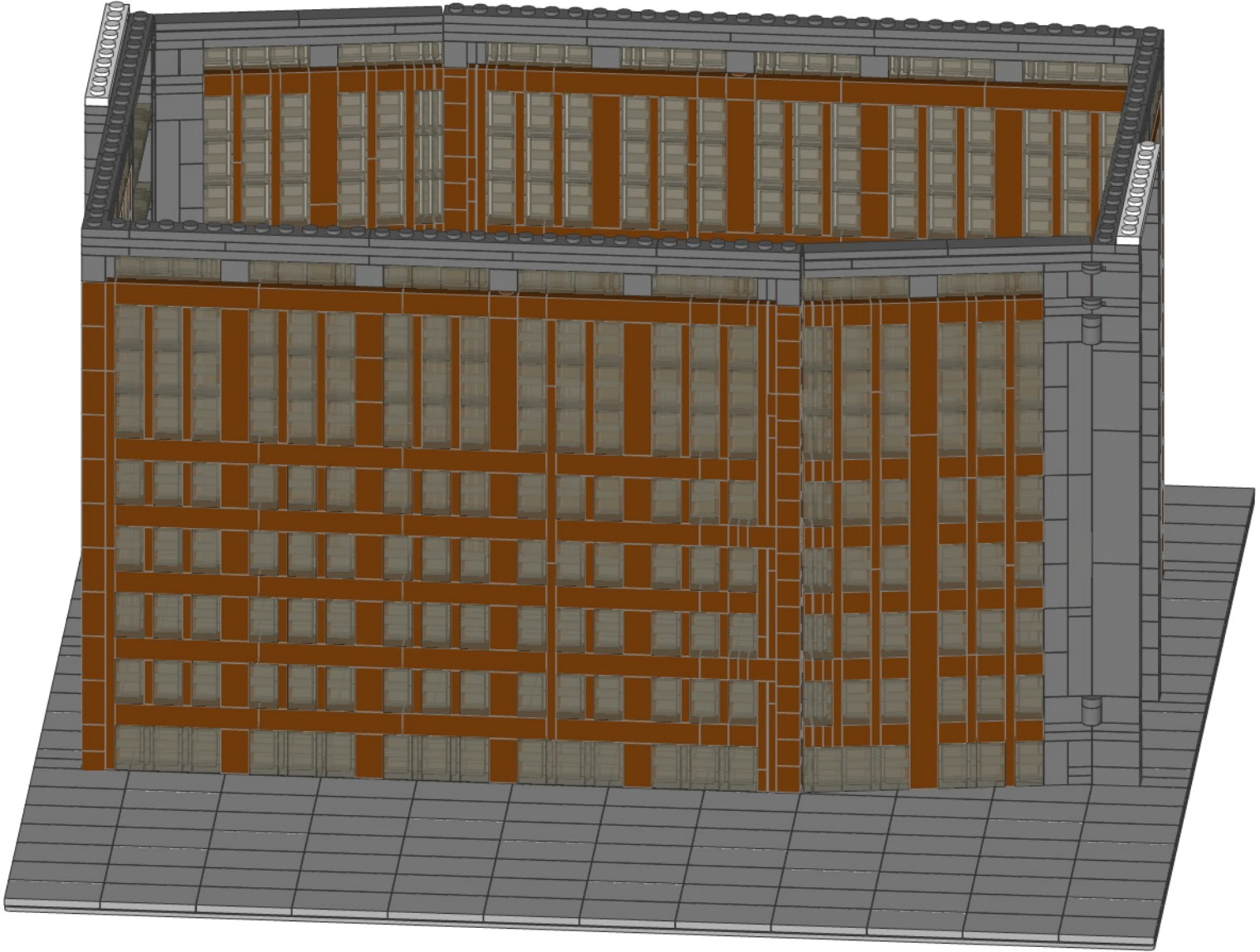
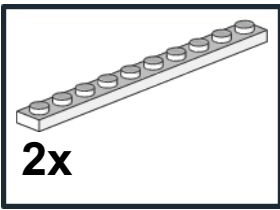

1

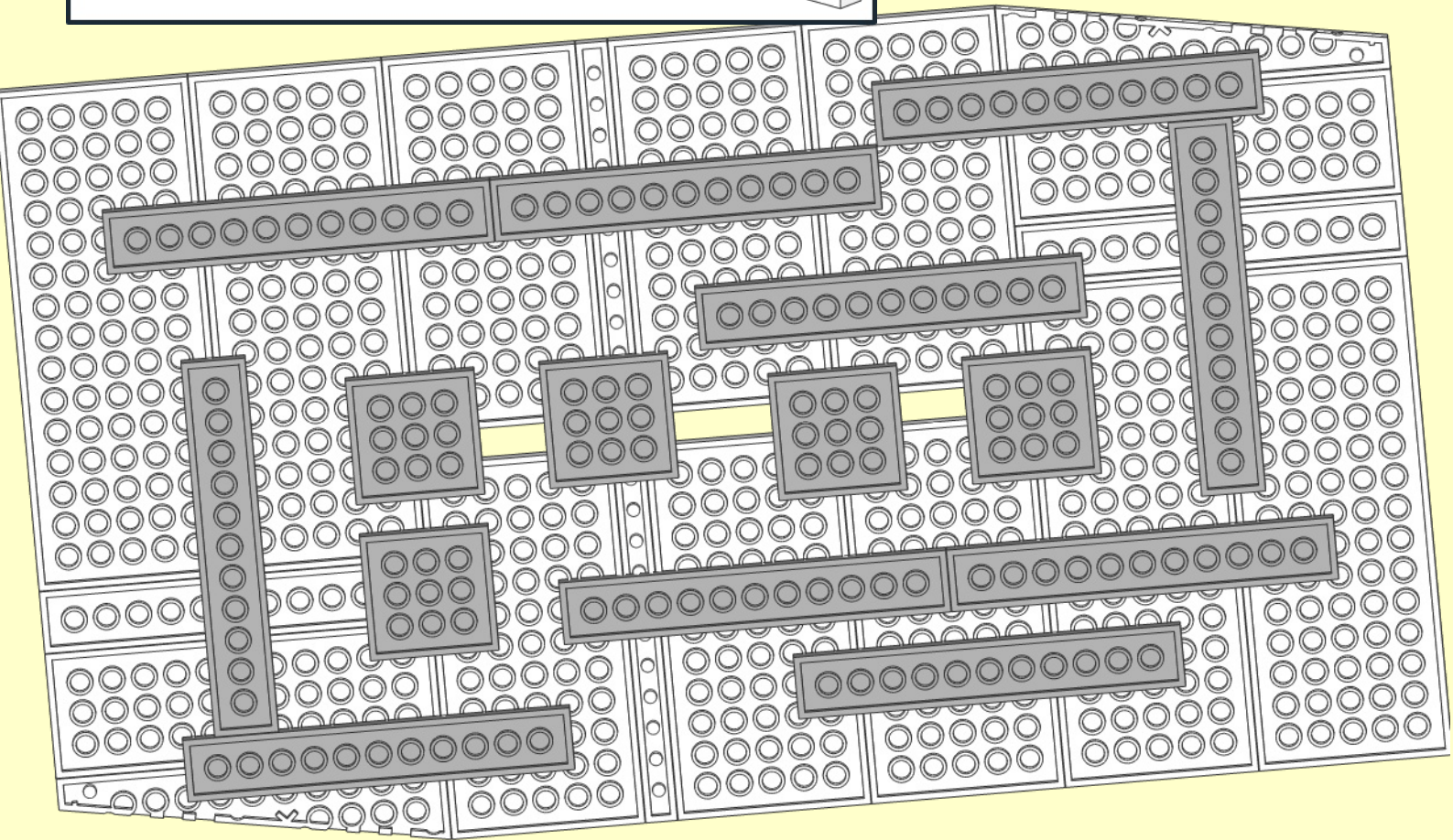
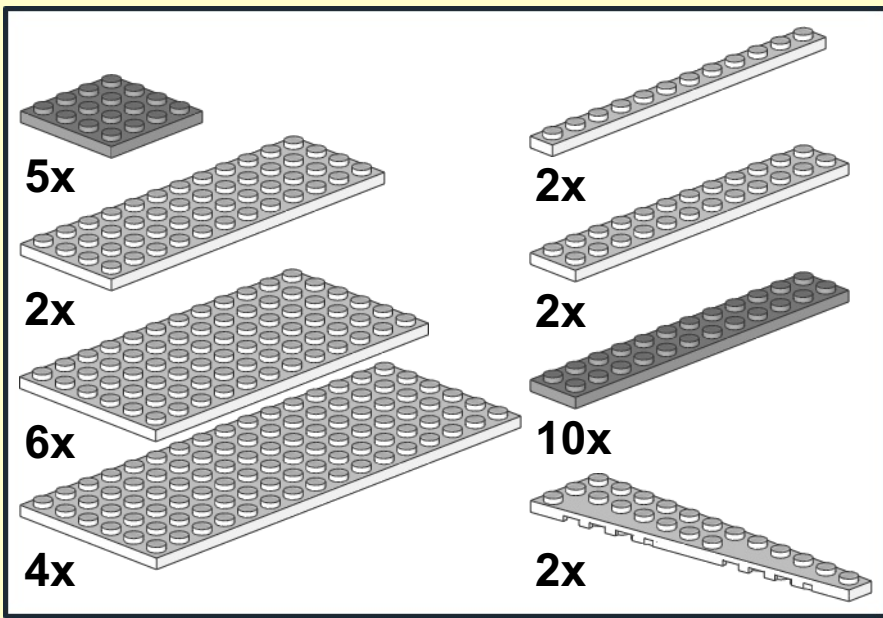

2

